

Appendices

Highways and Transport Proof of Evidence

Town and Country Planning Act 1990 **Section 78 appeal against the refusal of planning permission**

Witness: Paul Simon Goddard

Subject of Evidence: Highways and Transport

Appeal: APP/W0340/W/20/3265460

Site: Sandleford Park, Newtown Road, Newbury

Proposal: Outline planning permission for up to 1,000 new homes; an 80 extra care housing units (Use Class C3) as part of the affordable housing provision; a new 2 form entry primary school (D1); expansion land for Park House Academy School; a local centre to comprise flexible commercial floorspace (A1-A5 up to 2,150 sq m, B1a up to 200 sq m) and D1 use (up to 500sq m); the formation of new means of access onto Monks Lane; new open space including the laying out of a new country park; drainage infrastructure; walking and cycling infrastructure and other associated infrastructure works. Matters to be considered: Access.

Date: 07 April 2021

Council Reference: 20/01238/OUTMAJ

Content

1. VISSIM traffic modelling results.

2. Mitigation drawings:

A339 / B4640 Roundabout Improvement - Drawing 81311-041-108

A339 / Pinchington Lane / Monks Lane Roundabout Improvement – Drawing 172895/A/01/Rev C

A339 / A343 St Johns Road / Greenham Road Roundabout Improvement – Drawing 172985/A/12

Monks Lane Eastern Site Access – Drawing 172985_A_07.1 (Vectos drawing)

Monks Lane Western Site Access – Drawing 172985_A_08 (Vectos drawing)

Proposed vehicular/ pedestrian Valley Crossing straight alignment bridge and parallel structure – Drawings VD17562-SK023 and VD17562- STR-SK-003:

Further emergency route is also proposed along Public Right of Way Footpath Greenham 9

APPENDIX 1

VISSIM traffic modelling results.

	AM					PM					
	2031 Reference Case	Scenario A - with all dev	Scenario C - with Floor Homes	Scenario D - with DN Homes	Scenario A + mitigation	2031 Reference Case	Scenario A - with all dev	Scenario C - with Floor Homes	Scenario D - with DN Homes	Scenario A + mitigation	
11 - MCC 1 - A4 London Rd / Newport Rd / Faraday Rd SB	82.7	66.2	75.0	68.7	72.1	31.9	82.6	65.3	58.7	34.2	11 - MCC 1 - A4 London Rd / Newport Rd / Faraday Rd SB
12 - MCC 1 - A4 London Rd / Newport Rd / Faraday Rd WB RT	41.1	25.7	7.8	7.7	9.9	29.9	87.7	41.5	41.9	19.6	12 - MCC 1 - A4 London Rd / Newport Rd / Faraday Rd WB RT
13 - MCC 1 - A4 London Rd / Newport Rd / Faraday Rd WB Straight	424.8	402.9	416.2	421.4	416.0	127.3	295.0	233.3	194.6	153.1	13 - MCC 1 - A4 London Rd / Newport Rd / Faraday Rd WB Straight
14 - MCC 1 - A4 London Rd / Newport Rd / Faraday Rd WB Internal	43.0	43.1	43.7	42.4	43.4	22.7	41.7	41.3	40.6	35.4	14 - MCC 1 - A4 London Rd / Newport Rd / Faraday Rd WB Internal
15 - MCC 1 - A4 London Rd / Newport Rd / Faraday Rd WB LT	34.9	32.8	32.8	32.4	31.5	22.5	28.1	29.5	26.1	23.4	15 - MCC 1 - A4 London Rd / Newport Rd / Faraday Rd WB LT
16 - MCC 1 - A4 London Rd / Newport Rd / Faraday Rd NB	43.8	47.6	46.8	43.5	42.3	60.6	66.7	65.2	64.1	60.0	16 - MCC 1 - A4 London Rd / Newport Rd / Faraday Rd NB
17 - MCC 1 - A4 London Rd / Newport Rd / Faraday Rd EB RT	26.4	24.6	28.7	27.9	26.2	26.5	59.9	39.1	20.2	15.4	17 - MCC 1 - A4 London Rd / Newport Rd / Faraday Rd EB RT
18 - MCC 1 - A4 London Rd / Newport Rd / Faraday Rd EB Straight	113.2	115.7	111.5	111.6	113.0	91.2	120.5	109.6	95.1	92.6	18 - MCC 1 - A4 London Rd / Newport Rd / Faraday Rd EB Straight
19 - MCC 1 - A4 London Rd / Newport Rd / Faraday Rd EB Internal	46.1	47.5	45.8	44.5	43.5	41.5	43.9	42.2	42.4	40.9	19 - MCC 1 - A4 London Rd / Newport Rd / Faraday Rd EB Internal
21 - MCC 2 - A339 / Fleming Rd SB	64.1	83.9	82.8	75.7	83.4	445.8	825.8	717.2	745.8	340.7	21 - MCC 2 - A339 / Fleming Rd SB
22 - MCC 2 - A339 / Fleming Rd WB	32.7	26.9	29.0	25.9	26.6	310.3	308.9	314.4	318.3	315.3	22 - MCC 2 - A339 / Fleming Rd WB
23 - MCC 2 - A339 / Fleming Rd NB RT	53.4	57.6	60.1	55.9	47.9	44.0	52.0	53.2	52.3	42.9	23 - MCC 2 - A339 / Fleming Rd NB RT
24 - MCC 2 - A339 / Fleming Rd NB Straight	80.7	79.8	82.8	74.3	75.9	76.4	87.3	67.5	79.3	66.8	24 - MCC 2 - A339 / Fleming Rd NB Straight
31 - MCC 3 - Bear Lane Roundabout SB	123.3	134.7	142.8	139.1	145.4	414.7	426.8	436.0	426.9	430.3	31 - MCC 3 - Bear Lane Roundabout SB
32 - MCC 3 - Bear Lane Roundabout WB Straight	85.7	96.7	87.1	77.3	76.2	123.9	126.6	121.5	109.5	78.4	32 - MCC 3 - Bear Lane Roundabout WB Straight
33 - MCC 3 - Bear Lane Roundabout WB LT	92.6	103.1	94.9	88.3	83.7	132.3	136.4	130.9	121.1	87.3	33 - MCC 3 - Bear Lane Roundabout WB LT
34 - MCC 3 - Bear Lane Roundabout NB	65.6	87.2	71.8	78.7	91.2	96.7	193.5	86.4	94.2	235.9	34 - MCC 3 - Bear Lane Roundabout NB
35 - MCC 3 - Bear Lane Roundabout EB	56.0	56.5	55.2	55.3	59.1	54.3	54.5	54.1	50.3	59.3	35 - MCC 3 - Bear Lane Roundabout EB
41 - MCC 4 - A339 / Cheap St EB	18.2	18.6	16.6	17.6	18.9	21.9	22.9	23.0	23.0	24.9	41 - MCC 4 - A339 / Cheap St EB
51 - MCC 5 - St John's Roundabout SB	63.4	55.8	61.2	77.3	39.8	387.8	433.2	394.4	422.9	135.4	51 - MCC 5 - St John's Roundabout SB
52 - MCC 5 - St John's Roundabout WB	60.7	61.1	61.2	61.7	58.1	62.0	63.3	62.9	62.8	59.6	52 - MCC 5 - St John's Roundabout WB
53 - MCC 5 - St John's Roundabout NB	81.2	178.4	196.2	141.1	458.9	67.6	84.6	86.4	122.0	270.8	53 - MCC 5 - St John's Roundabout NB
54 - MCC 5 - St John's Roundabout EB	260.6	170.2	264.5	217.1	275.0	77.0	99.4	78.5	91.8	184.3	54 - MCC 5 - St John's Roundabout EB
61 - MCC 6 - A339 / Pinchington Ln Roundabout SB	58.6	49.1	50.2	45.1	106.7	49.7	42.7	42.8	34.0	119.9	61 - MCC 6 - A339 / Pinchington Ln Roundabout SB
62 - MCC 6 - A339 / Pinchington Ln Roundabout SB LT	15.0	16.6	13.3	15.7	106.9	14.4	13.2	13.4	14.5	120.0	62 - MCC 6 - A339 / Pinchington Ln Roundabout SB LT
63 - MCC 6 - A339 / Pinchington Ln Roundabout WB	83.1	61.6	66.5	71.9	82.5	104.2	103.9	114.0	93.5	125.5	63 - MCC 6 - A339 / Pinchington Ln Roundabout WB
64 - MCC 6 - A339 / Pinchington Ln Roundabout NB	375.4	256.9	267.6	224.1	306.4	578.4	344.1	343.6	337.8	337.5	64 - MCC 6 - A339 / Pinchington Ln Roundabout NB
65 - MCC 6 - A339 / Pinchington Ln Roundabout EB	53.2	71.3	63.6	62.6	0.3	54.0	50.3	57.2	62.3	0.4	65 - MCC 6 - A339 / Pinchington Ln Roundabout EB
71 - MCC 7 - Bear Lane / Wharf Car Park SB	3.6	5.0	3.2	3.7	9.4	9.1	11.0	10.3	5.3	70.3	71 - MCC 7 - Bear Lane / Wharf Car Park SB
72 - MCC 7 - Bear Lane / Wharf Car Park WB	14.1	12.7	11.1	11.3	15.9	14.5	20.2	19.8	17.9	23.4	72 - MCC 7 - Bear Lane / Wharf Car Park WB
73 - MCC 7 - Bear Lane / Wharf Car Park EB	37.8	54.0	37.7	33.3	81.1	20.6	21.4	15.7	9.1	81.2	73 - MCC 7 - Bear Lane / Wharf Car Park EB
81 - MCC 8 - Bear Lane / Market Place SB	54.7	60.7	56.1	55.8	68.6	53.2	62.5	57.4	53.4	73.9	81 - MCC 8 - Bear Lane / Market Place SB
82 - MCC 8 - Bear Lane / Market Place WB	4.5	3.8	2.9	3.2	3.6	7.1	8.8	9.9	11.4	12.1	82 - MCC 8 - Bear Lane / Market Place WB
83 - MCC 8 - Bear Lane / Market Place NB	60.0	77.2	62.8	53.5	120.9	50.2	53.8	53.5	49.5	198.6	83 - MCC 8 - Bear Lane / Market Place NB
91 - MCC 9 - Bartholemew St / Pound St SB	55.0	76.0	63.9	50.1	67.9	73.8	96.3	97.1	93.1	81.5	91 - MCC 9 - Bartholemew St / Pound St SB
92 - MCC 9 - Bartholemew St / Pound St NB	130.5	247.9	201.6	182.5	140.4	83.5	74.6	72.5	75.8	74.2	92 - MCC 9 - Bartholemew St / Pound St NB
93 - MCC 9 - Bartholemew St / Pound St EB	95.8	107.9	120.9	104.4	76.6	40.2	39.0	39.3	38.1	40.5	93 - MCC 9 - Bartholemew St / Pound St EB
101 - MCC 10 - A343 / Newtown Rd SB	51.0	31.5	54.8	37.5	46.1	15.9	23.1	19.0	21.7	43.7	101 - MCC 10 - A343 / Newtown Rd SB
102 - MCC 10 - A343 / Newtown Rd WB	49.9	122.9	80.9	82.3	74.8	69.1	102.5	124.2	114.6	123.5	102 - MCC 10 - A343 / Newtown Rd WB
103 - MCC 10 - A343 / Newtown Rd NB	49.6	68.0	92.4	41.3	114.5	23.0	28.8	30.2	25.5	55.2	103 - MCC 10 - A343 / Newtown Rd NB
104 - MCC 10 - A343 / Newtown Rd EB	83.9	323.4	216.6	185.0	131.8	18.6	19.1	15.4	17.1	44.6	104 - MCC 10 - A343 / Newtown Rd EB
111 - MCC 11 - A343 / Essex St SB	55.5	37.6	49.0	46.2	60.2	50.6	47.4	51.5	61.1	41.9	111 - MCC 11 - A343 / Essex St SB
112 - MCC 11 - A343 / Essex St WB	25.7	22.9	26.6	24.0	21.8	89.7	67.8	50.0	88.2	54.5	112 - MCC 11 - A343 / Essex St WB

113 - MCC 11 - A343 / Essex St NB	69.9	76.8	78.3	89.2	79.6	78.2	74.3	129.6	90.1	68.4	113 - MCC 11 - A343 / Essex St NB
114 - MCC 11 - A343 / Essex St EB	58.7	57.5	57.8	66.4	60.9	38.3	34.1	34.7	37.0	28.6	114 - MCC 11 - A343 / Essex St EB
121 - MCC 12 - Andover Rd / Falkland Rd SB	4.2	5.9	16.7	9.4	2.9	12.6	7.5	11.5	17.3	6.4	121 - MCC 12 - Andover Rd / Falkland Rd SB
122 - MCC 12 - Andover Rd / Falkland Rd WB	2.4	2.2	2.5	2.6	2.1	6.4	4.6	4.4	4.6	4.3	122 - MCC 12 - Andover Rd / Falkland Rd WB
123 - MCC 12 - Andover Rd / Falkland Rd NB	18.0	19.0	21.6	24.4	12.0	17.5	13.2	26.0	12.5	9.8	123 - MCC 12 - Andover Rd / Falkland Rd NB
124 - MCC 12 - Andover Rd / Falkland Rd EB	4.7	4.5	5.4	6.4	5.1	0.4	0.0	0.0	0.0	0.0	124 - MCC 12 - Andover Rd / Falkland Rd EB
125 - MCC 12 - Andover Rd / Falkland Rd EB Petrol Station	13.2	12.7	15.1	14.8	11.2	15.2	13.1	19.7	16.5	13.3	125 - MCC 12 - Andover Rd / Falkland Rd EB Petrol Station
131 - MCC 13 - Andover Rd / Warren Rd SB	8.5	9.7	17.5	12.8	10.3	4.6	10.7	4.9	4.7	9.7	131 - MCC 13 - Andover Rd / Warren Rd SB
132 - MCC 13 - Andover Rd / Warren Rd WB	2.7	16.9	3.4	30.4	19.2	4.7	10.8	4.2	10.3	10.8	132 - MCC 13 - Andover Rd / Warren Rd WB
133 - MCC 13 - Andover Rd / Warren Rd NB	9.6	29.7	13.0	28.5	32.8	20.5	39.5	1.1	9.1	28.4	133 - MCC 13 - Andover Rd / Warren Rd NB
134 - MCC 13 - Andover Rd / Warren Rd EB	0.9	1.1	0.7	1.9	1.0	0.2	1.3	0.6	0.4	1.2	134 - MCC 13 - Andover Rd / Warren Rd EB
141 - MCC 14 - Monks Ln / Newbury Rugby Club NB	9.4	9.3	10.6	9.0	9.2	18.9	15.8	15.1	16.7	15.6	141 - MCC 14 - Monks Ln / Newbury Rugby Club NB
142 - MCC 14 - Monks Ln / Newbury Rugby Club EB	19.8	18.5	29.4	16.9	15.6	16.0	12.9	20.7	16.1	16.3	142 - MCC 14 - Monks Ln / Newbury Rugby Club EB
151 - MCC 15 - Monks Ln / Newtown Rd SB	38.5	74.8	65.0	62.2	88.2	35.6	34.7	35.4	40.6	62.0	151 - MCC 15 - Monks Ln / Newtown Rd SB
152 - MCC 15 - Monks Ln / Newtown Rd WB	20.8	22.7	20.3	19.8	48.7	14.2	18.2	16.8	15.5	52.3	152 - MCC 15 - Monks Ln / Newtown Rd WB
153 - MCC 15 - Monks Ln / Newtown Rd NB	11.2	11.2	10.7	10.5	36.0	19.4	19.0	18.3	17.5	56.1	153 - MCC 15 - Monks Ln / Newtown Rd NB
154 - MCC 15 - Monks Ln / Newtown Rd EB	20.8	35.6	29.5	22.6	83.0	15.6	15.5	16.7	17.3	55.6	154 - MCC 15 - Monks Ln / Newtown Rd EB
161 - MCC 16 - Pinchington Ln / Retail Park SB	13.3	14.2	14.1	14.6	17.9	29.8	30.9	33.8	30.9	52.2	161 - MCC 16 - Pinchington Ln / Retail Park SB
162 - MCC 16 - Pinchington Ln / Retail Park WB	44.9	27.9	30.8	34.7	4.9	103.6	113.1	132.6	105.8	31.1	162 - MCC 16 - Pinchington Ln / Retail Park WB
163 - MCC 16 - Pinchington Ln / Retail Park EB	11.6	12.2	10.8	11.0	40.0	14.3	14.0	12.6	14.7	29.4	163 - MCC 16 - Pinchington Ln / Retail Park EB
171 - MCC 17 - Pinchington Ln / Premier Inn WB	22.4	18.6	19.7	19.8	8.4	28.1	40.9	48.9	34.7	9.7	171 - MCC 17 - Pinchington Ln / Premier Inn WB
172 - MCC 17 - Pinchington Ln / Premier Inn NB	21.7	19.2	19.0	19.8	19.8	82.1	113.2	147.6	71.2	43.0	172 - MCC 17 - Pinchington Ln / Premier Inn NB
173 - MCC 17 - Pinchington Ln / Premier Inn EB	11.6	10.7	7.7	9.0	4.4	16.1	13.9	17.9	14.9	7.2	173 - MCC 17 - Pinchington Ln / Premier Inn EB
181 - MCC 18 - Pinchington Ln / Greenham Rd SB	32.4	26.9	28.0	29.9	32.4	23.2	24.0	20.6	23.2	21.2	181 - MCC 18 - Pinchington Ln / Greenham Rd SB
182 - MCC 18 - Pinchington Ln / Greenham Rd WB	22.0	19.3	18.4	19.7	20.6	24.9	29.4	26.7	25.2	23.0	182 - MCC 18 - Pinchington Ln / Greenham Rd WB
183 - MCC 18 - Pinchington Ln / Greenham Rd EB	17.3	20.8	17.5	17.0	19.3	18.7	18.0	17.9	18.6	19.6	183 - MCC 18 - Pinchington Ln / Greenham Rd EB
191 - MCC 19 - Greenham Rd / Racecourse Rd SB	11.5	14.6	11.1	11.6	16.4	19.7	13.6	14.3	15.5	21.1	191 - MCC 19 - Greenham Rd / Racecourse Rd SB
192 - MCC 19 - Greenham Rd / Racecourse Rd WB	68.9	32.8	49.4	51.0	23.0	17.5	16.0	20.0	23.1	15.9	192 - MCC 19 - Greenham Rd / Racecourse Rd WB
193 - MCC 19 - Greenham Rd / Racecourse Rd NB	325.8	224.7	261.3	192.2	59.7	21.9	24.3	29.8	34.1	18.3	193 - MCC 19 - Greenham Rd / Racecourse Rd NB
201 - MCC 20 - Kings Rd / Sainsbury's WB	9.2	7.6	8.1	8.3	16.4	7.2	7.2	6.3	7.0	12.4	201 - MCC 20 - Kings Rd / Sainsbury's WB
202 - MCC 20 - Kings Rd / Sainsbury's NB	50.5	51.6	52.0	47.2	24.5	73.9	72.5	73.5	67.2	31.1	202 - MCC 20 - Kings Rd / Sainsbury's NB
203 - MCC 20 - Kings Rd / Sainsbury's EB	53.9	48.8	47.6	48.1	26.3	51.8	52.4	60.1	55.6	23.1	203 - MCC 20 - Kings Rd / Sainsbury's EB
211 - MCC 21 - Sainsburys access SB	7.5	6.5	6.7	6.3	4.9	10.6	9.2	11.4	10.6	8.3	211 - MCC 21 - Sainsburys access SB
212 - MCC 21 - Sainsburys access WB	19.1	18.6	21.7	15.6	19.0	35.7	30.1	50.9	22.5	37.8	212 - MCC 21 - Sainsburys access WB
213 - MCC 21 - Sainsburys access NB	4.9	5.0	5.1	4.6	4.7	4.8	5.1	5.7	4.9	5.9	213 - MCC 21 - Sainsburys access NB
214 - MCC 21 - Sainsburys access EB	11.9	10.7	12.0	11.3	11.1	40.2	38.1	39.7	26.6	20.2	214 - MCC 21 - Sainsburys access EB
221 - MCC 22 - Kings Rd / Hambridge Rd SB	33.7	163.9	60.5	103.1	123.3	14.7	69.5	20.6	86.3	37.7	221 - MCC 22 - Kings Rd / Hambridge Rd SB
222 - MCC 22 - Kings Rd / Hambridge Rd NB	108.6	173.7	139.4	143.6	150.4	108.2	84.3	67.3	71.5	87.2	222 - MCC 22 - Kings Rd / Hambridge Rd NB
231 - MCC 23 - Hambridge Rd / Bone Ln SB	155.1	303.1	269.1	223.3	206.6	119.7	139.9	177.3	126.9	68.7	231 - MCC 23 - Hambridge Rd / Bone Ln SB
232 - MCC 23 - Hambridge Rd / Bone Ln WB	33.6	29.1	28.0	29.0	24.3	141.8	112.7	109.5	90.0	115.4	232 - MCC 23 - Hambridge Rd / Bone Ln WB
233 - MCC 23 - Hambridge Rd / Bone Ln EB	243.5	332.6	250.7	271.3	385.5	44.5	126.1	72.4	107.3	55.3	233 - MCC 23 - Hambridge Rd / Bone Ln EB
241 - MCC 24 - Hambridge Rd / Hambridge Ln SB	329.4	279.4	198.6	317.0	219.4	135.2	228.0	173.8	166.3	128.8	241 - MCC 24 - Hambridge Rd / Hambridge Ln SB
242 - MCC 24 - Hambridge Rd / Hambridge Ln WB	15.3	16.3	15.5	15.3	15.5	64.6	77.4	71.7	67.6	51.7	242 - MCC 24 - Hambridge Rd / Hambridge Ln WB
243 - MCC 24 - Hambridge Rd / Hambridge Ln NB	123.3	111.8	95.2	87.1	89.0	19.1	16.6	17.9	17.7	16.6	243 - MCC 24 - Hambridge Rd / Hambridge Ln NB
244 - MCC 24 - Hambridge Rd / Hambridge Ln EB	37.4	38.1	47.1	50.2	33.0	488.8	563.9	547.1	547.9	449.2	244 - MCC 24 - Hambridge Rd / Hambridge Ln EB
251 - MCC 25 - London Rd / Hambridge Rd SB	148.0	138.1	164.3	150.5	133.0	123.0	134.5	135.1	130.8	139.0	251 - MCC 25 - London Rd / Hambridge Rd SB
252 - MCC 25 - London Rd / Hambridge Rd WB	206.3	198.0	288.1	286.3	241.8	79.6	82.9	78.3	76.6	87.0	252 - MCC 25 - London Rd / Hambridge Rd WB
253 - MCC 25 - London Rd / Hambridge Rd NB	71.0	70.5	74.2	78.3	68.4	96.6	95.5	95.4	95.9	97.2	253 - MCC 25 - London Rd / Hambridge Rd NB
254 - MCC 25 - London Rd / Hambridge Rd NB LT	72.4	71.7	75.5	79.7	69.8	98.0	96.9	96.8	97.3	98.6	254 - MCC 25 - London Rd / Hambridge Rd NB LT
255 - MCC 25 - London Rd / Hambridge Rd EB	81.7	78.7	77.5	79.0	78.9	137.4	135.5	131.0	139.1	134.5	255 - MCC 25 - London Rd / Hambridge Rd EB
261 - MCC 26 - Racecourse Rd / Boundary Rd SB	4.3	4.1	3.6	3.8	4.1	6.5	6.1	6.6	6.9	6.4	261 - MCC 26 - Racecourse Rd / Boundary Rd SB
262 - MCC 26 - Racecourse Rd / Boundary Rd WB	13.7	30.3	13.5	14.3	14.5	8.8	9.4	9.9	6.9	6.0	262 - MCC 26 - Racecourse Rd / Boundary Rd WB
263 - MCC 26 - Racecourse Rd / Boundary Rd EB	9.3	18.0	8.0	8.9	9.2	8.4	5.3	5.3	2.5	4.1	263 - MCC 26 - Racecourse Rd / Boundary Rd EB
271 - MCC 27 - Greenham Rd / Queens Rd SB	4.0	3.1	3.1	3.6	3.7	15.9	12.4	13.9	13.0	13.3	271 - MCC 27 - Greenham Rd / Queens Rd SB

272 - MCC 27 - Greenham Rd / Queens Rd WB	91.2	60.6	48.5	52.2	40.5	176.5	103.8	152.8	147.0	115.9	272 - MCC 27 - Greenham Rd / Queens Rd WB
273 - MCC 27 - Greenham Rd / Queens Rd NB	202.5	200.4	194.9	206.9	104.5	87.2	102.9	132.6	120.9	68.8	273 - MCC 27 - Greenham Rd / Queens Rd NB
274 - MCC 27 - Greenham Rd / Queens Rd EB	11.2	11.8	14.2	13.2	12.4	25.2	26.1	25.0	24.9	26.8	274 - MCC 27 - Greenham Rd / Queens Rd EB
281 - MCC 28 - Pinchington Ln / Haysoms Dr SB	3.7	4.4	3.3	3.3	3.8	2.8	2.3	2.7	2.7	2.5	281 - MCC 28 - Pinchington Ln / Haysoms Dr SB
282 - MCC 28 - Pinchington Ln / Haysoms Dr WB	16.0	12.7	12.5	14.0	10.1	12.1	14.4	13.5	13.6	11.4	282 - MCC 28 - Pinchington Ln / Haysoms Dr WB
283 - MCC 28 - Pinchington Ln / Haysoms Dr NB	9.9	9.0	8.9	9.8	8.6	4.9	5.2	5.9	5.7	5.2	283 - MCC 28 - Pinchington Ln / Haysoms Dr NB
284 - MCC 28 - Pinchington Ln / Haysoms Dr EB	2.0	4.3	3.8	2.5	4.3	1.6	2.2	2.1	2.2	2.8	284 - MCC 28 - Pinchington Ln / Haysoms Dr EB
291 - MCC 29 - Bartholomew St / Craven Rd SB	1.9	3.7	6.0	3.2	2.8	8.9	13.0	11.7	11.3	12.3	291 - MCC 29 - Bartholomew St / Craven Rd SB
292 - MCC 29 - Bartholomew St / Craven Rd NB	69.8	95.1	70.2	63.7	83.1	17.1	17.2	16.3	15.4	27.8	292 - MCC 29 - Bartholomew St / Craven Rd NB
293 - MCC 29 - Bartholomew St / Craven Rd EB	83.3	117.8	78.7	75.6	146.6	20.1	19.2	17.6	18.1	39.7	293 - MCC 29 - Bartholomew St / Craven Rd EB
301 - MCC 30- Bartholomew St / Market St WB RT	46.4	42.4	35.4	38.9	40.3	49.1	56.9	55.7	57.3	49.9	301 - MCC 30- Bartholomew St / Market St WB RT
302 - MCC 30- Bartholomew St / Market St NB	76.6	76.3	75.9	76.2	75.6	61.6	58.5	58.9	58.8	65.6	302 - MCC 30- Bartholomew St / Market St NB
311 - MCC 31 - Market St / WBC SB	0.4	0.5	0.4	0.6	0.9	3.6	2.5	2.6	2.2	7.2	311 - MCC 31 - Market St / WBC SB
312 - MCC 31 - Market St / WBC WB	44.7	43.7	37.1	34.4	37.2	25.2	33.2	32.9	35.7	38.7	312 - MCC 31 - Market St / WBC WB
313 - MCC 31 - Market St / WBC NB	18.4	17.7	16.5	16.6	17.5	31.8	36.7	35.2	36.0	35.0	313 - MCC 31 - Market St / WBC NB
314 - MCC 31 - Market St / WBC EB	7.2	8.8	7.6	6.7	14.0	5.9	5.6	6.1	5.3	9.6	314 - MCC 31 - Market St / WBC EB
321 - MCC 32 - Market St / Cheap St NB	75.4	88.6	68.0	67.1	84.4	57.0	65.3	64.1	62.6	144.8	321 - MCC 32 - Market St / Cheap St NB
322 - MCC 32 - Market St / Cheap St EB	74.9	83.2	70.3	68.4	97.4	55.9	55.1	54.3	52.3	88.6	322 - MCC 32 - Market St / Cheap St EB
323 - MCC 32 - Market St / Cheap St SB	57.8	54.3	56.1	54.2	59.7	50.0	59.9	57.9	56.2	61.6	323 - MCC 32 - Market St / Cheap St SB
331 - MCC 33 - Cheap St / Cheap St NB	0.0	0.0	0.0	0.0	0.0	0.0	0.1	0.1	0.0	1.3	331 - MCC 33 - Cheap St / Cheap St NB
332 - MCC 33 - Cheap St / Cheap St EB	0.0	0.0	0.0	0.0	0.1	0.0	0.1	0.0	0.1	0.1	332 - MCC 33 - Cheap St / Cheap St EB
341 - MCC 34 - Shaw Rd / Kiln Rd SB	30.6	28.9	29.8	26.2	30.2	27.8	20.4	19.3	21.4	21.4	341 - MCC 34 - Shaw Rd / Kiln Rd SB
342 - MCC 34 - Shaw Rd / Kiln Rd WB	72.9	70.9	70.9	76.0	69.3	40.7	35.9	34.5	35.9	38.9	342 - MCC 34 - Shaw Rd / Kiln Rd WB
343 - MCC 34 - Shaw Rd / Kiln Rd NB	26.1	23.8	27.4	23.8	26.4	33.7	26.1	25.7	28.4	30.1	343 - MCC 34 - Shaw Rd / Kiln Rd NB
344 - MCC 34 - Shaw Rd / Kiln Rd EB	6.7	7.8	7.7	7.6	8.0	0.9	1.3	1.4	1.5	1.4	344 - MCC 34 - Shaw Rd / Kiln Rd EB
351 - MCC 35 - Kiln Rd / Walton Way WB	30.8	25.8	27.9	25.9	26.6	26.7	20.6	21.1	21.7	21.9	351 - MCC 35 - Kiln Rd / Walton Way WB
352 - MCC 35 - Kiln Rd / Walton Way NB	16.3	20.0	20.3	20.4	18.0	13.7	26.1	26.8	24.9	19.6	352 - MCC 35 - Kiln Rd / Walton Way NB
353 - MCC 35 - Kiln Rd / Walton Way EB	34.9	34.7	37.2	37.2	34.0	32.4	32.8	34.8	31.0	31.6	353 - MCC 35 - Kiln Rd / Walton Way EB
361 - MCC 36 - London Rd / Newbury Business Park WB	278.7	203.7	254.8	210.5	219.5	163.3	240.5	227.1	185.0	219.5	361 - MCC 36 - London Rd / Newbury Business Park WB
362 - MCC 36 - London Rd / Newbury Business Park NB	11.7	11.3	11.4	11.6	11.0	15.5	17.9	16.3	15.6	16.5	362 - MCC 36 - London Rd / Newbury Business Park NB
363 - MCC 36 - London Rd / Newbury Business Park EB	76.8	82.8	82.0	61.6	70.0	83.6	69.0	81.6	71.7	71.8	363 - MCC 36 - London Rd / Newbury Business Park EB
364 - MCC 36 - London Rd / Newbury Business Park SB	8.7	8.5	8.1	8.0	8.0	33.7	37.8	37.4	36.7	38.1	364 - MCC 36 - London Rd / Newbury Business Park SB
371 - MCC 37 - Mill Ln / Bone Ln WB	0.1	16.1	0.1	2.8	6.2	0.2	1.2	0.2	4.2	0.2	371 - MCC 37 - Mill Ln / Bone Ln WB
372 - MCC 37 - Mill Ln / Bone Ln SB	2.7	6.0	2.9	4.1	6.5	1.6	2.3	1.7	3.5	1.5	372 - MCC 37 - Mill Ln / Bone Ln SB
381 - MCC 38 - Andover Rd / Buckingham Rd SB	53.9	75.1	82.9	102.6	97.4	10.4	9.6	8.0	11.3	10.0	381 - MCC 38 - Andover Rd / Buckingham Rd SB
382 - MCC 38 - Andover Rd / Buckingham Rd NB	26.5	196.2	118.1	140.1	62.0	1.4	1.6	1.0	1.8	4.7	382 - MCC 38 - Andover Rd / Buckingham Rd NB
383 - MCC 38 - Andover Rd / Buckingham Rd EB	16.0	30.6	24.0	30.1	22.6	2.8	2.4	2.9	2.2	3.6	383 - MCC 38 - Andover Rd / Buckingham Rd EB
391 - MCC 39 - London Rd / Tesco WB	120.7	81.3	107.9	77.9	104.6	13.5	67.2	38.9	26.8	22.9	391 - MCC 39 - London Rd / Tesco WB
392 - MCC 39 - London Rd / Tesco NB	24.6	19.5	23.0	16.6	21.2	16.0	29.9	20.8	18.3	17.9	392 - MCC 39 - London Rd / Tesco NB
393 - MCC 39 - London Rd / Tesco NB RT	15.3	15.4	15.5	15.5	15.4	15.5	15.4	15.4	15.4	15.5	393 - MCC 39 - London Rd / Tesco NB RT
394 - MCC 39 - London Rd / Tesco EB	289.1	237.7	210.9	225.8	222.5	24.8	8.4	11.5	23.7	8.1	394 - MCC 39 - London Rd / Tesco EB
395 - 40 - A339 School Access SB	60.4	69.4	65.0	63.9	15.9	279.6	62.1	62.0	62.2	8.3	395 - 40 - A339 School Access SB
396 - 40 - A339 School Access NB	125.0	107.8	102.3	92.2	111.8	177.9	358.9	311.2	166.8	320.3	396 - 40 - A339 School Access NB
397 - 40 - A339 School Access EB	8.2	36.7	14.8	8.3	40.3	136.9	19.4	8.6	4.4	20.3	397 - 40 - A339 School Access EB
399 - Robin Hood - A339 SB	111.8	120.7			125.8	279.6	471.8			158.8	399 - Robin Hood - A339 SB
400 - Robin Hood - B4009 WB	73.3	79.4			70.4	177.9	123.7			111.4	400 - Robin Hood - B4009 WB
401 - Robin Hood - A4 London Road WB	190.1	185.4			183.0	136.9	171.6			133.9	401 - Robin Hood - A4 London Road WB
402 - Robin Hood - A339 NB	104.7	111.8			112.4	103.7	111.3			92.4	402 - Robin Hood - A339 NB
403 - Robin Hood - London Rd EB	45.9	47.8			49.0	101.7	155.0			81.8	403 - Robin Hood - London Rd EB
404 - Robin Hood - Western Ave EB	53.5	53.8			54.8	68.5	70.1			60.4	404 - Robin Hood - Western Ave EB

The 2031 Reference Case model covers the highway network as projected in 2031.

Scenario A includes the total development from both planning applications 20/01238/OUTMAJ and 18/00828/OUTMAJ.

Scenario C includes the Bloor Homes part of Sandleford Park

Scenario D includes the Donnington New Homes Bloor Homes part of Sandleford Park

Interpreting the Traffic Modelling Results

Red – a significant increase in traffic queues, generally where traffic queues have increased by more than circa 100 metres (18 passenger car units). Would generally be sufficient to raise objection.

Amber – an increase in traffic queues. The extent is generally not, or not quite sufficient to raise objection

Green – a decrease in traffic queues, an improvement.

No colour – no comments

Yellow – for the 2031 reference case to enable comparison.

APPENDIX 2

Mitigation drawings:

A339 / B4640 Roundabout Improvement - Drawing 81311-041-108

A339 / Pinchington Lane / Monks Lane Roundabout Improvement – Drawing 172895/A/01/Rev C

A339 / A343 St Johns Road / Greenham Road Roundabout Improvement – Drawing 172985/A/12

Monks Lane Eastern Site Access – Drawing 172985_A_07.1 (Vectos drawing)

Monks Lane Western Site Access – Drawing 172985_A_08 (Vectos drawing)

Proposed vehicular/ pedestrian Valley Crossing straight alignment bridge and parallel structure – Drawings VD17562-SK023 and VD17562- STR-SK-003:

Further emergency route is also proposed along Public Right of Way Footpath Greenham 9 (CD 1.5).

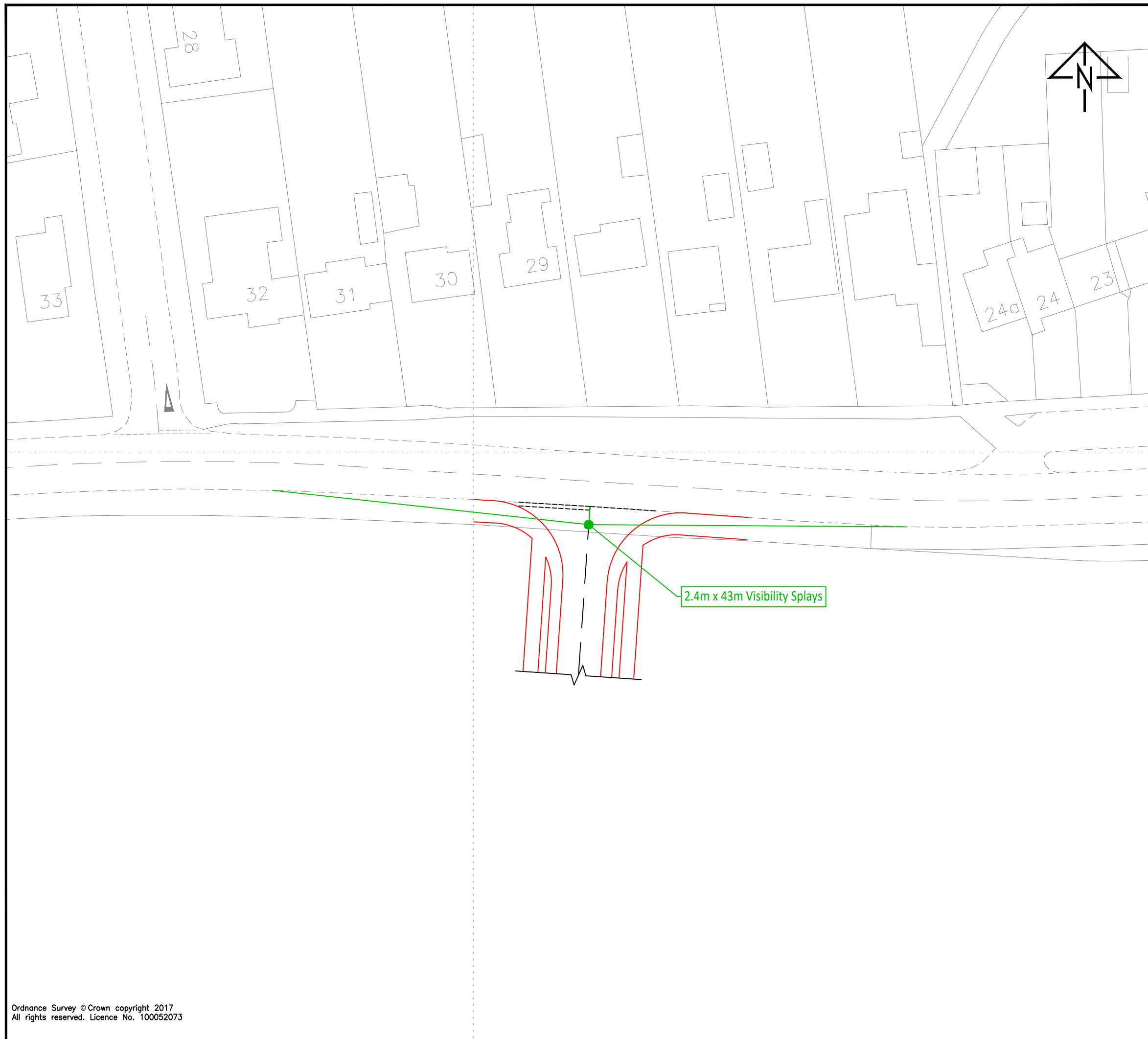

Notes:
1. Drawing is subject to Section 278 Agreement

REV.	A	Visibility splays added	CJM	TF	23.09.2020
		DETAILS	DRAWN	CHECKED	DATE

CLIENT:
Bloor Homes

PROJECT:
**Sandleford Park
Newbury**

DRAWING TITLE:
Eastern Site Access

SCALES:
1:500 at A3

DRAWN:	TF	CHECKED:	ES	DATE:	13.03.2018
--------	----	----------	----	-------	------------



Network Building, 97 Tottenham Court Road, London W1T 4TP
t: 020 7580 7373 e: enquiries@vectos.co.uk

DRAWING NUMBER:	172985/A/07.1	REVISION:	A
-----------------	----------------------	-----------	----------

Ordnance Survey © Crown copyright 2017
All rights reserved. Licence No. 100052073

NOTE: THE PROPERTY OF THIS DRAWING AND DESIGN IS VESTED IN VECTOS (SOUTH) LTD.
IT MUST NOT BE COPIED OR REPRODUCED IN ANY WAY WITHOUT THEIR PRIOR WRITTEN CONSENT.

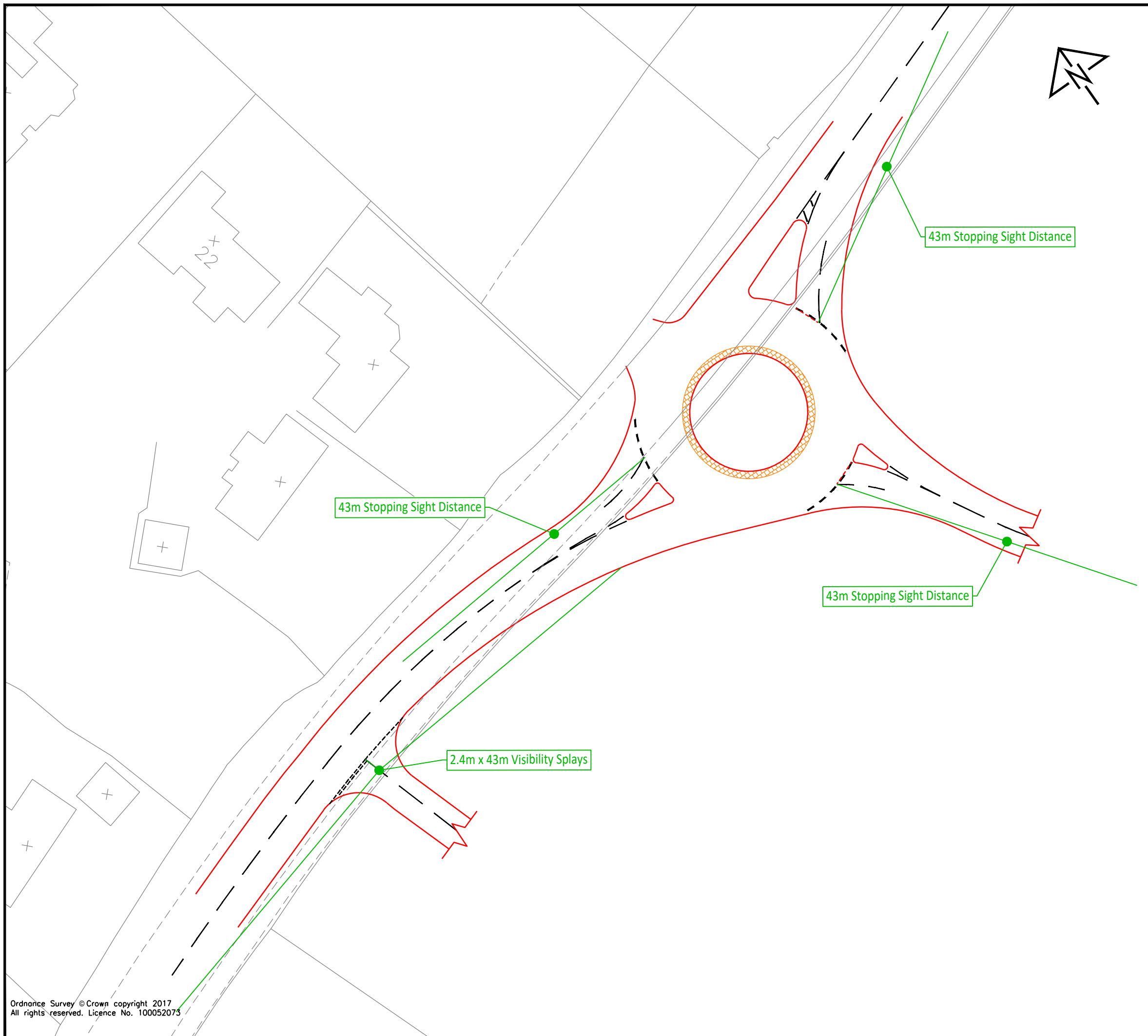

Notes:

1. Drawing is subject to Section 278 agreement

REV.	DESCRIPTION	DRAWN	CHECKED	DATE
A	Visibility splays added	CJM	TF	23.09.2020

CLIENT:
Bloor Homes

PROJECT:
**Sandleford Park
Newbury**

DRAWING TITLE:
Western Junction Access

SCALES:
1:500 at A3

DRAWN: SC CHECKED: AW DATE: 19/03/2018

vectos.

Network Building, 97 Tottenham Court Road, London W1T 4TP
t: 020 7580 7373 e: enquiries@vectos.co.uk

DRAWING NUMBER: **172985/A/08** REVISION: **A**

Ordnance Survey © Crown copyright 2017
All rights reserved. Licence No. 100052073

NOTE: THE PROPERTY OF THIS DRAWING AND DESIGN IS VESTED IN VECTOS (SOUTH) LTD.
IT MUST NOT BE COPIED OR REPRODUCED IN ANY WAY WITHOUT THEIR PRIOR WRITTEN CONSENT.

DO NOT SCALE

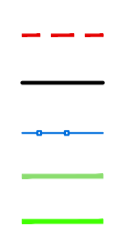
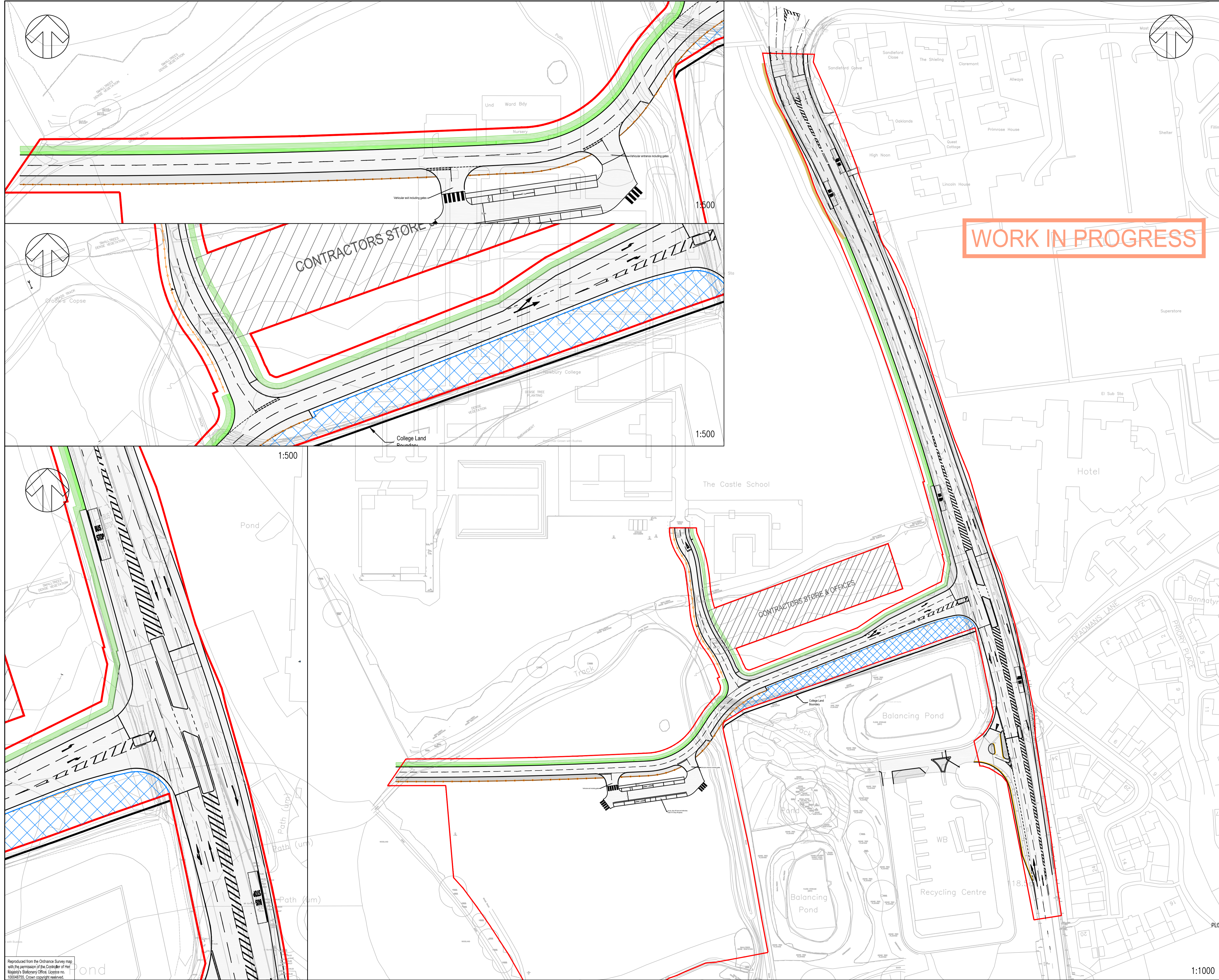

REV	DATE	BY	DESCRIPTION	CHK	APP
B	30/11/2017	AMS	DESIGN AMENDMENTS - CLIENT'S COMMENTS	FL	SB
A	16/11/2017	AMS	FIRST ISSUE	FL	SB

DRAWING STATUS: FOR INFORMATION ONLY

wsp
 Regus House, Southampton International Business Park
 George Curl Way, Southampton, Hampshire, SO18 2RZ
 Tel: +44 (0)2380 302529 Fax: +44 (0)2380 302001
 www.wsp.com

CLIENT: West Berkshire Council

ARCHITECT: -

PROJECT: A339 Sandleford, Newbury

TITLE: General Arrangement Plan

SCALE @ A1:	AS SHOW	CHECKED:	FL	APPROVED:	SB
CAD FILE:	PL011-27599-010 ROAD LAYOUT - REV C	DESIGN/DRAWN:	AMS	DATE:	September 2017

PROJECT No:	DRAWING No:	REV:
70034768	4768-SK-100	B

1:1000

© WSP Group Ltd

X:\PROJECTS\170000\172985 - SANDLEFORD PARK (INCOMING) WEST BERKSHIRE COUNCIL\2018-01-23 - A339-NEW COLLEGE ACCESS JUNCTION\PL011-27599-010 ROAD LAYOUT - REV C.DWG 24/01/2018 09:36:59 David Noyce

Reproduced from the Ordnance Survey map with the permission of the Controller of Her Majesty's Stationery Office. Licence no. 100048755. Crown copyright reserved.

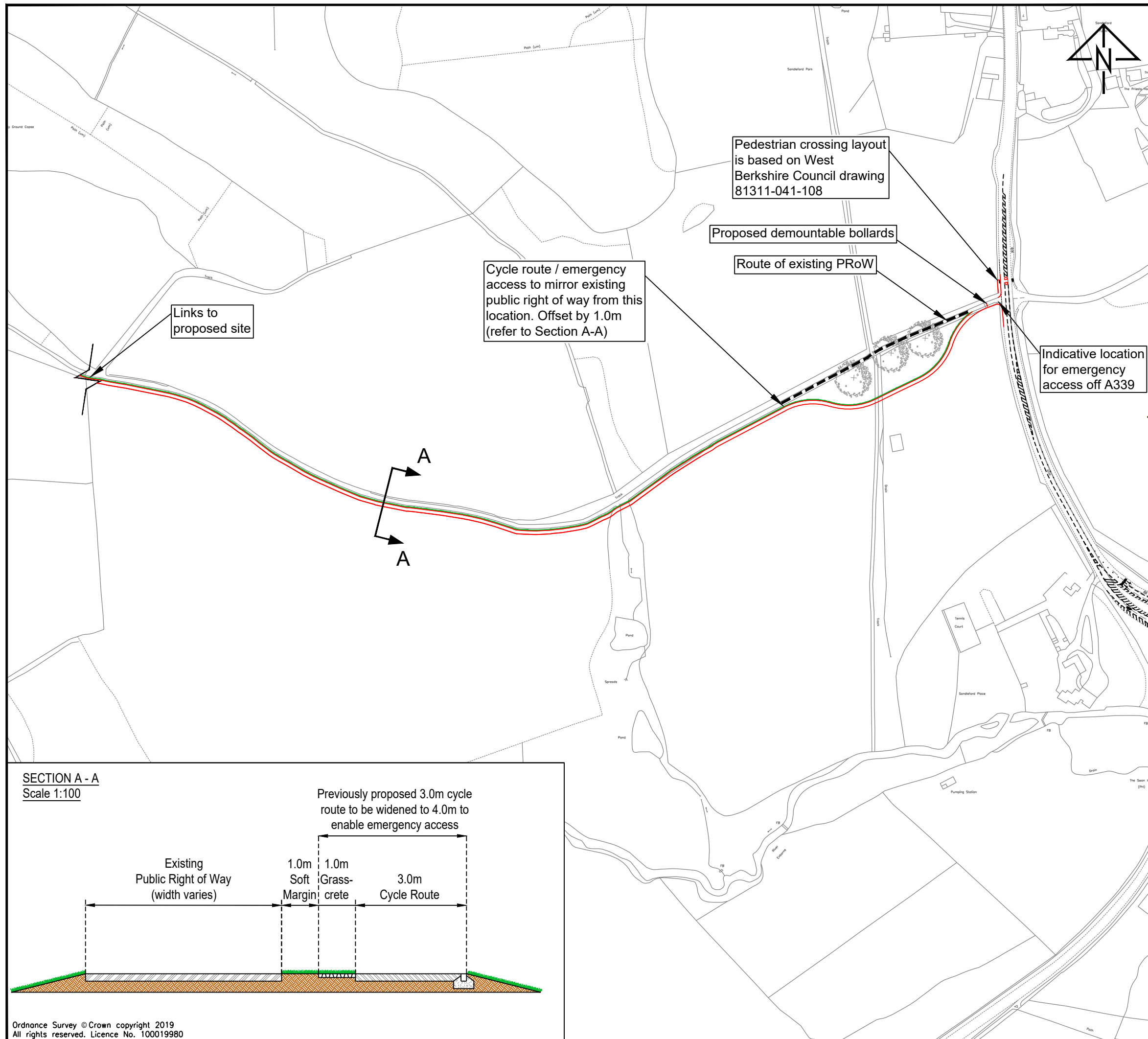

- Notes:**
1. This is not a construction drawing and is intended for illustrative purposes only.
 2. White lining is indicative only.

REV.	DETAILS	DRAWN	CHECKED	DATE
-	-	-	-	-

CLIENT:
Bloor Homes

PROJECT:
**Sandleford Park,
Newbury**

DRAWING TITLE:
**Illustrative Cycle Route /
Emergency Access
Option 3**

SCALES:
NTS / 1:100 at A3

DRAWN: **JB** CHECKED: **AW** DATE: **17.10.2019**



Network Building, 97 Tottenham Court Road, London W1T 4TP
t: 020 7580 7373 e: enquiries@vectos.co.uk

DRAWING NUMBER: **172985/A/15** REVISION: **-**

SECTION A - A
Scale 1:100

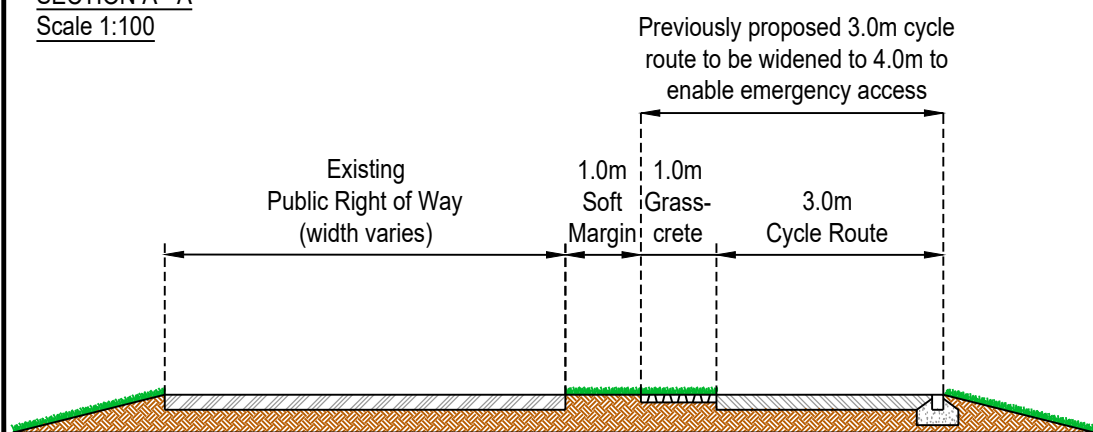

Ordnance Survey © Crown copyright 2019
All rights reserved. Licence No. 100019980

NOTE: THE PROPERTY OF THIS DRAWING AND DESIGN IS VESTED IN VECTOS (SOUTH) LTD.
IT MUST NOT BE COPIED OR REPRODUCED IN ANY WAY WITHOUT THEIR PRIOR WRITTEN CONSENT.

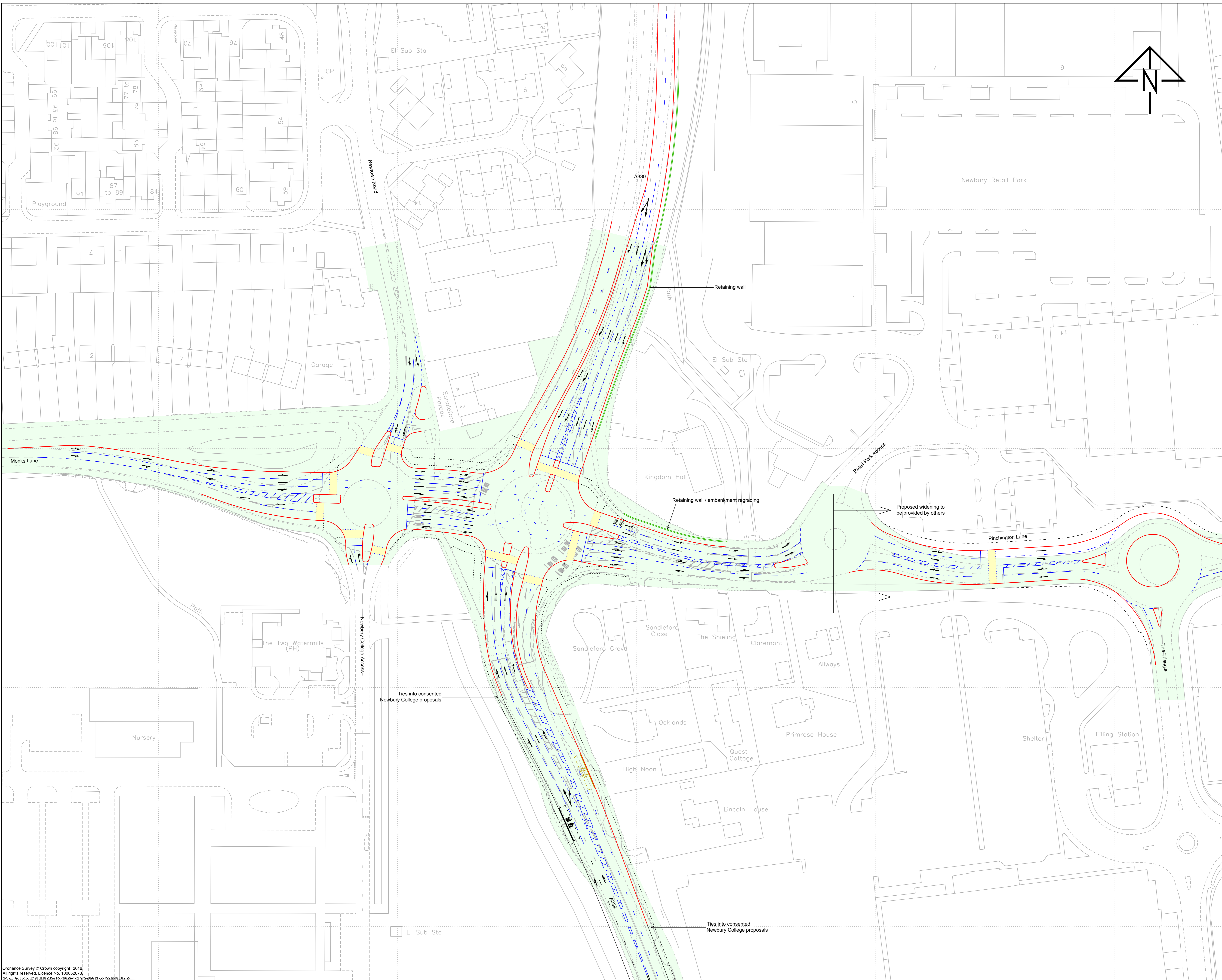

Notes:
 1. This is not a construction drawing and is intended for illustrative purposes only.
 2. White Brng is indicative only.

REV	DETAILS	DRAWN	CHECKED	DATE
C	Revisions following additional modelling	DSN	AW	15.12.2017
B	Revisions following comments from VBC	DSN	KH	7.3.2018
A	Junctions revised following initial comments from WBC	DSN	KH	13.12.2017

CLIENT: **Bloor Homes**

PROJECT: **SANDLEFORD PARK NEWBURY**

DRAWING TITLE: **A339 / Pinchington Lane / Monks Lane Junction Possible Signalisation Scheme**

SCALE: **1:500 at A0**

DRAWN	DSN	CHECKED	DATE	27.10.2017
-------	-----	---------	------	------------

 Network Building, 97 Tottenham Court Road, London W1T 4TP
 t: 020 7580 7373 e: enquiries@vectoros.co.uk

DRAWING NUMBER: **172985/A/01** REVISION: **C**

Ordnance Survey © Crown copyright 2016.
 All rights reserved. Licence No. 100052073.
 VECTOROS IS THE PROPERTY OF VECTOROS TRANSPORT PLANNING SPECIALISTS LTD.

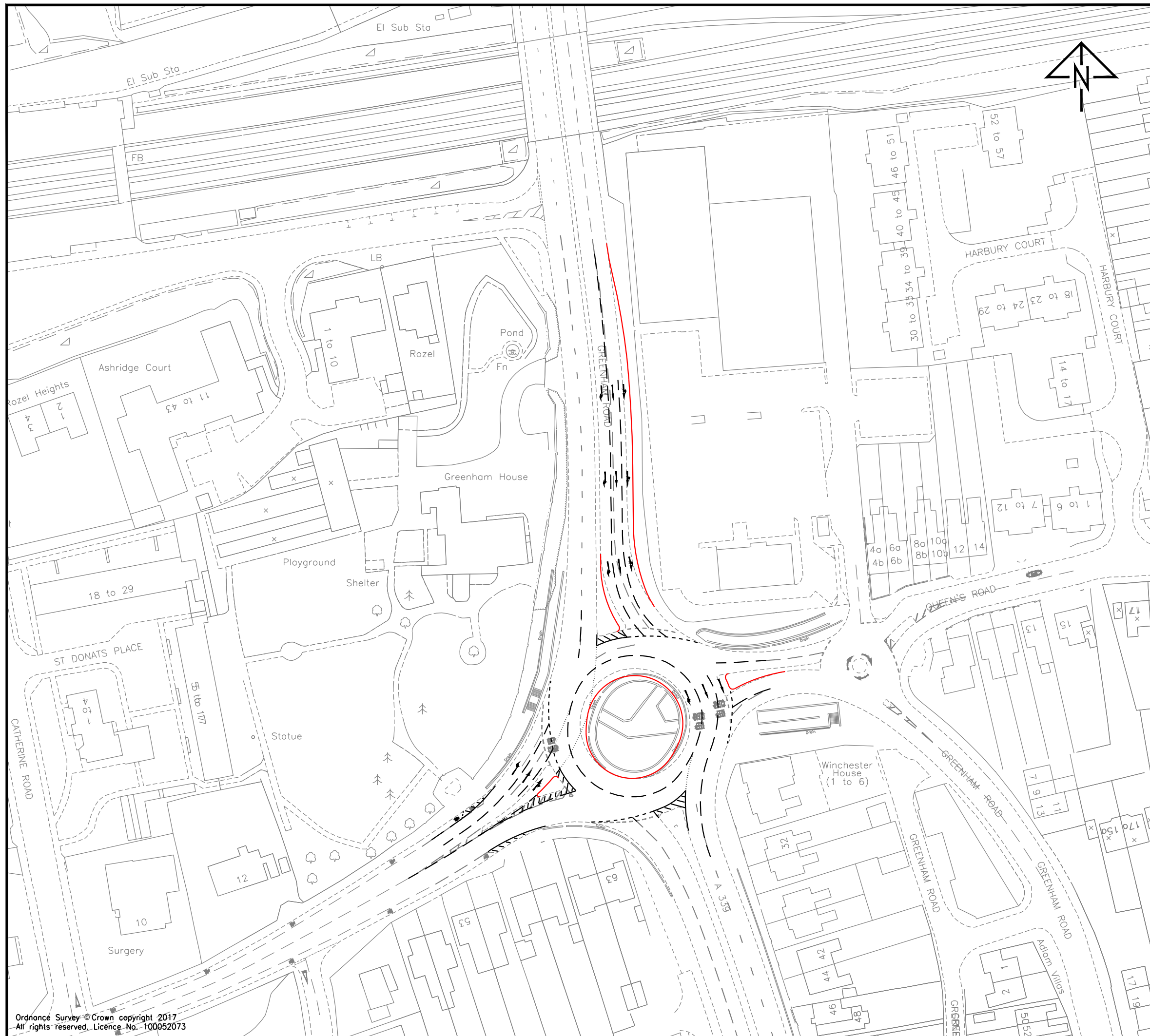

Notes:

1. This is not a construction drawing and is intended for illustrative purposes only.
2. White lining is indicative only.

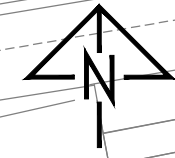

REV.	DETAILS	DRAWN	CHECKED	DATE

CLIENT:
Bloor Homes

PROJECT:
**Sandleford Park
Newbury**

DRAWING TITLE:
**Proposed Capacity Improvements
A339 / A343 Roundabout**

SCALES:
1:1000 at A3

DRAWN: JM CHECKED: AW DATE: 21.06.2019



Network Building, 97 Tottenham Court Road, London W1T 4TP
t: 020 7580 7373 e: enquiries@vectos.co.uk

DRAWING NUMBER: **172985/A/12** REVISION: .

Ordnance Survey © Crown copyright 2017
All rights reserved. Licence No. 100052073

NOTE: THE PROPERTY OF THIS DRAWING AND DESIGN IS VESTED IN VECTOS (SOUTH) LTD.
IT MUST NOT BE COPIED OR REPRODUCED IN ANY WAY WITHOUT THEIR PRIOR WRITTEN CONSENT.

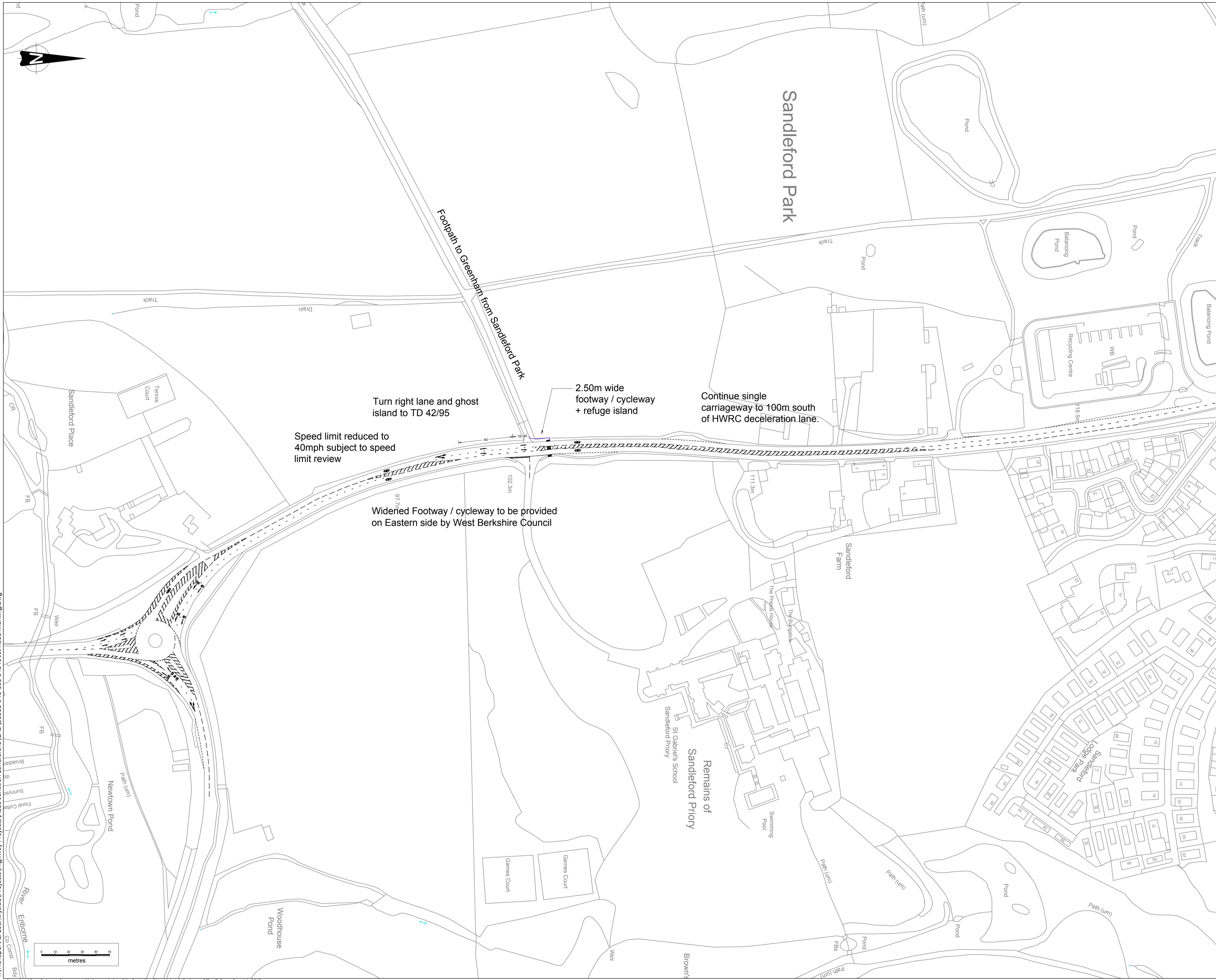

KEY
 — Road Markings

- NOTES**
- 1) All dimensions are shown in metres unless shown otherwise.
 - 2) This drawing shows a proposed option and is subject to change following the location, depth and height of existing utility services.
 - 3) WBC Standard Details must be adhered to at all times unless specified by a WBC Engineer.
 - 4) Prior to any excavations the contractor will establish the location of existing utility services.

DRAFT

B				
A				
REV	DESCRIPTION	DR	AU	REV DATE
Status				



Transport & Countryside | Council Offices
 Market Street | Newbury | RG14 5LD

Project Title				
A339 Sandlerford				
Drawing Title				
A339/B4640 Junction Road Marking				
Date	Drawn By	Checked By	Paper Size	Drawing Scale
18/04/2016	AT	NS	A1	1:1250
Drawing Number			Revision	
81311-041-108				

Reproduced from Ordnance Survey map with the permission of the Controller of Her Majesty's Stationery Office © Crown Copyright 2017. Unauthorised reproduction infringes Crown Copyright and may lead to prosecution or civil proceedings. West Berkshire District Council 100015913.