

# Transport Overview for Newbury

Jon Winstanley & Jenny Graham  
West Berkshire Council

# What we will cover...

---

- ❑ Background: Newbury Vision and the context of Newbury

- ❑ What is planned for transport in Newbury?



- ❑ Current consultation on A339 scheme

# Newbury 2026 – Freedom to Grow

- ❑ Enhance the Gateways to the North and the South of Newbury and the linkages between them
- ❑ Enable real travel choices to encourage as many journeys as possible to be made by rail, bus, walking and cycling
- ❑ **Actions included in the Vision:**
  - Develop a cycle hub
  - Improve Newbury Railway Station
  - Implement a car club
  - Improve and promote bus links
  - Improvements to the road network



# Context: Air Quality

- ❑ Air Quality Management Area declared May 2009
- ❑ Action Plan



## Change

*the way you move*



Newbury

Air Quality Action Plan

West Berkshire Council



West Berkshire  
COUNCIL



West Berkshire  
COUNCIL



# Context: Development in Newbury

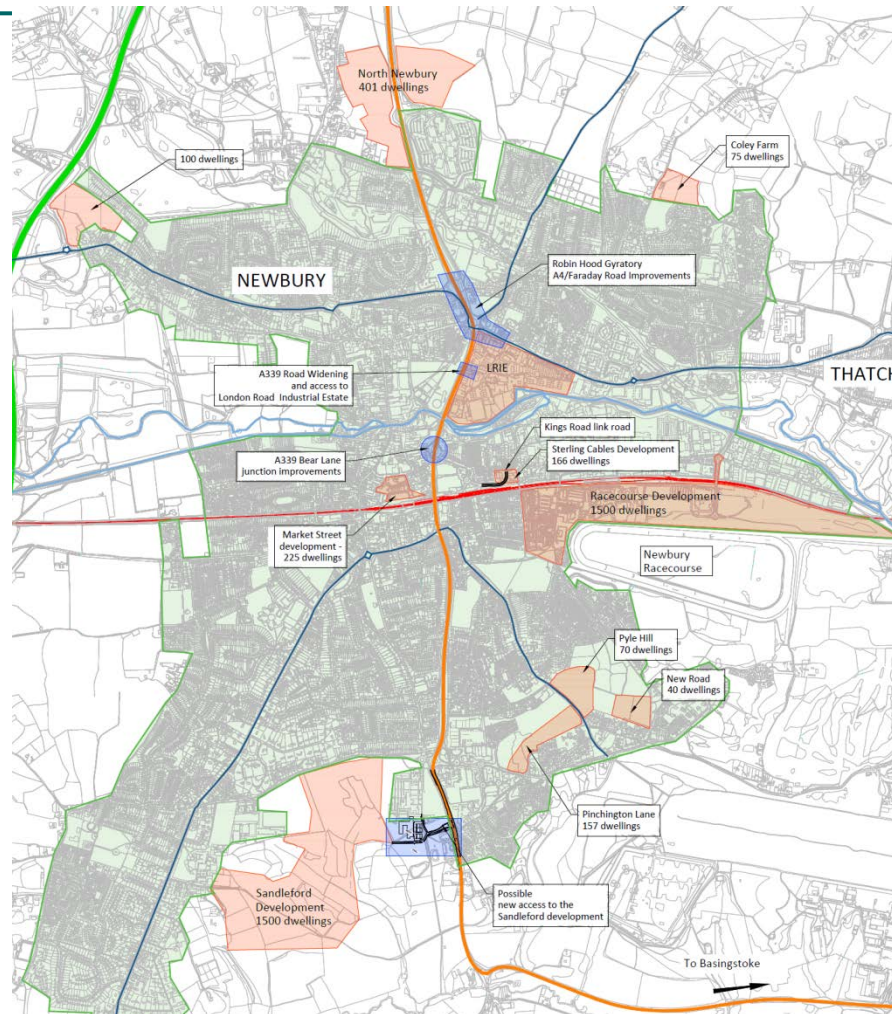

# Walking





- ❑ LRIE new junction – helping to overcome severance for pedestrians

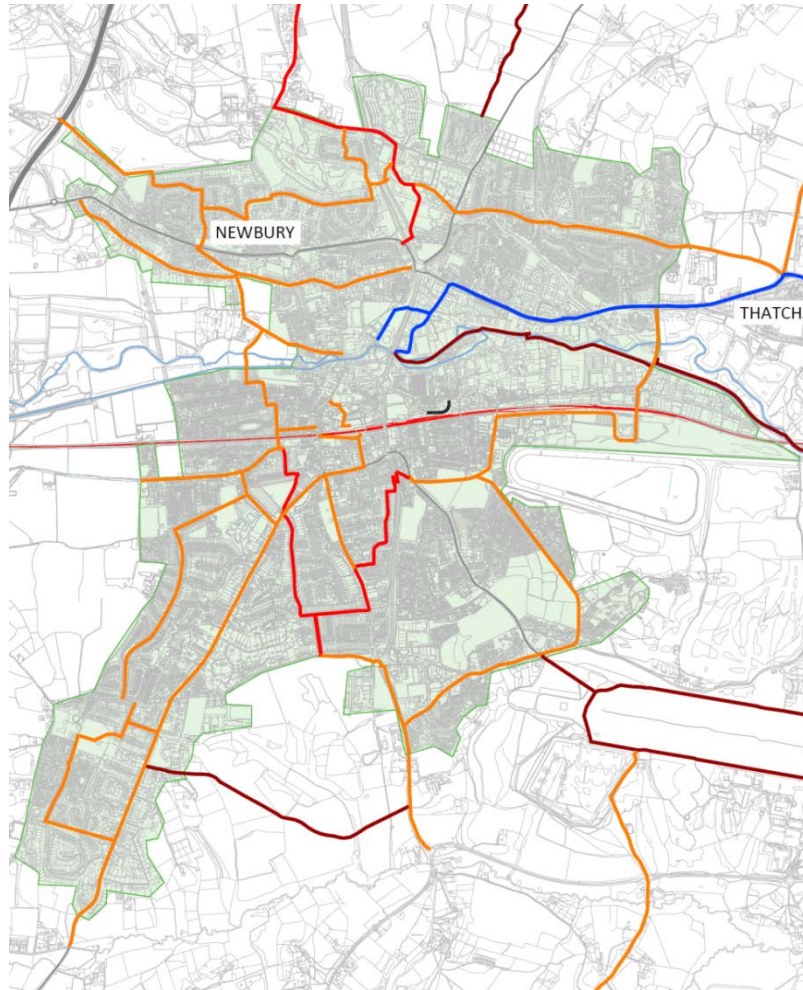

# Cycling overview



## KEY

-  = New Sustrans National Cycle Route
-  = New Primary Route
-  = New Secondary Route
-  = New Off-Road Recreational Route



# Cycling – NCN 422



- ❑ National Cycle Network – New Route 422
- ❑ Developed with other unitary authorities
- ❑ Significant funding from:



**Thames  
Valley  
Berkshire**  
LOCAL ENTERPRISE PARTNERSHIP



# NCN 422 route

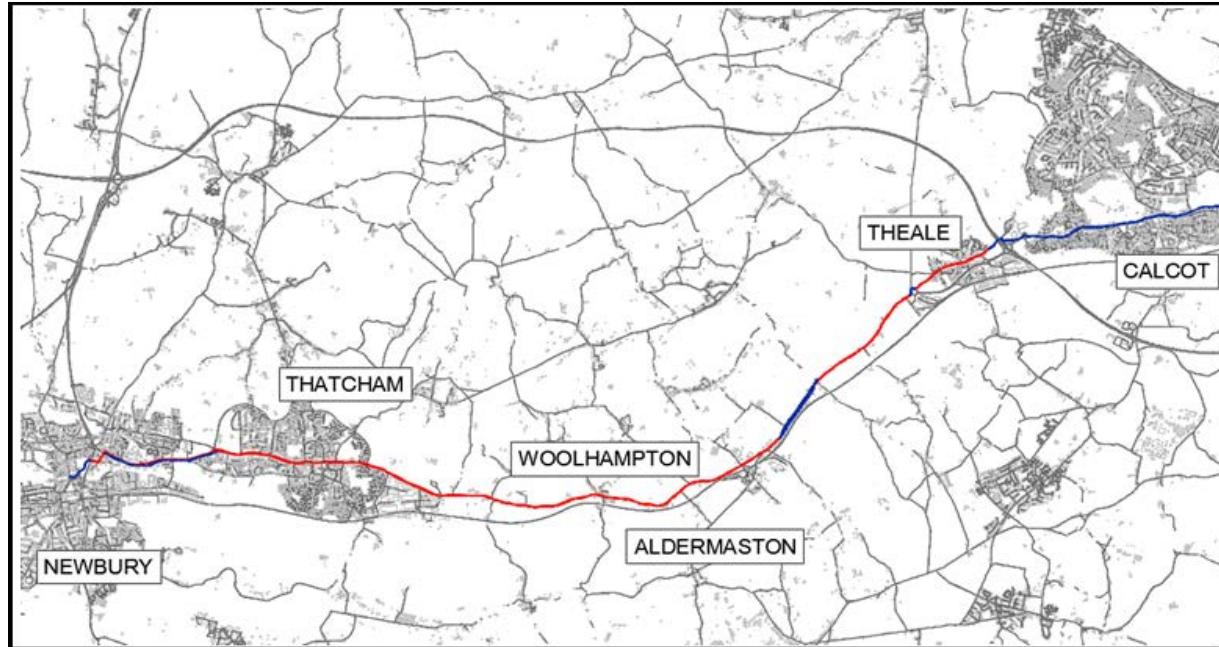

- ❑ Route starts in Newbury and links through to Windsor
- ❑ In West Berkshire it largely follows the A4 corridor

# Public Transport

---

- ❑ Improvements to and promotion of bus services
- ❑ Newbury Railway Station Improvement Project
- ❑ New bus interchange facility – The Wharf



# Changes to Bus Services



- ❑ New contract won by Reading Buses with new services which started in September 2016
- ❑ Recent launch of Jet Red



# Bus Services: improving information

- ❑ Next Buses – Real Time Information
- ❑ Transport Near Me



# Newbury Station Improvements

---

## Objectives of Project:

1. Improve access and interchange
2. Create a vibrant and attractive gateway to Newbury
3. Modernise the station's buildings to meet future demands
4. Contribute to solutions for flooding issues
5. Reduce severance between the south of Newbury and the town centre



# Possible Layout

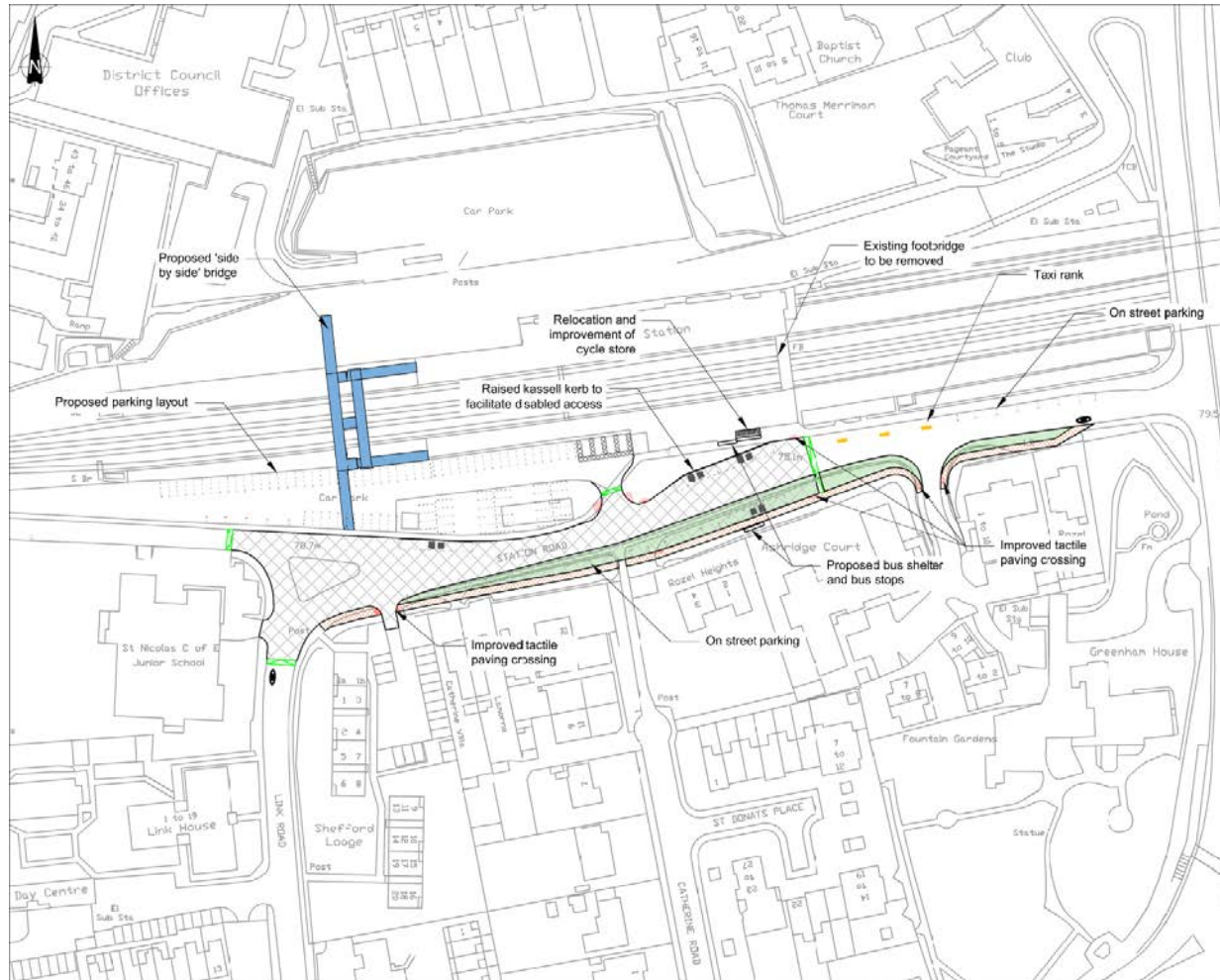



# South side station entrance – current view



# South side entrance – possible enhancement

---



(source GWR architect drawing)



# North side – current view



# North side entrance – possible reconfiguration and enhancement

---



□ (Source GWR architect drawing)

# Bus Interchange – The Wharf

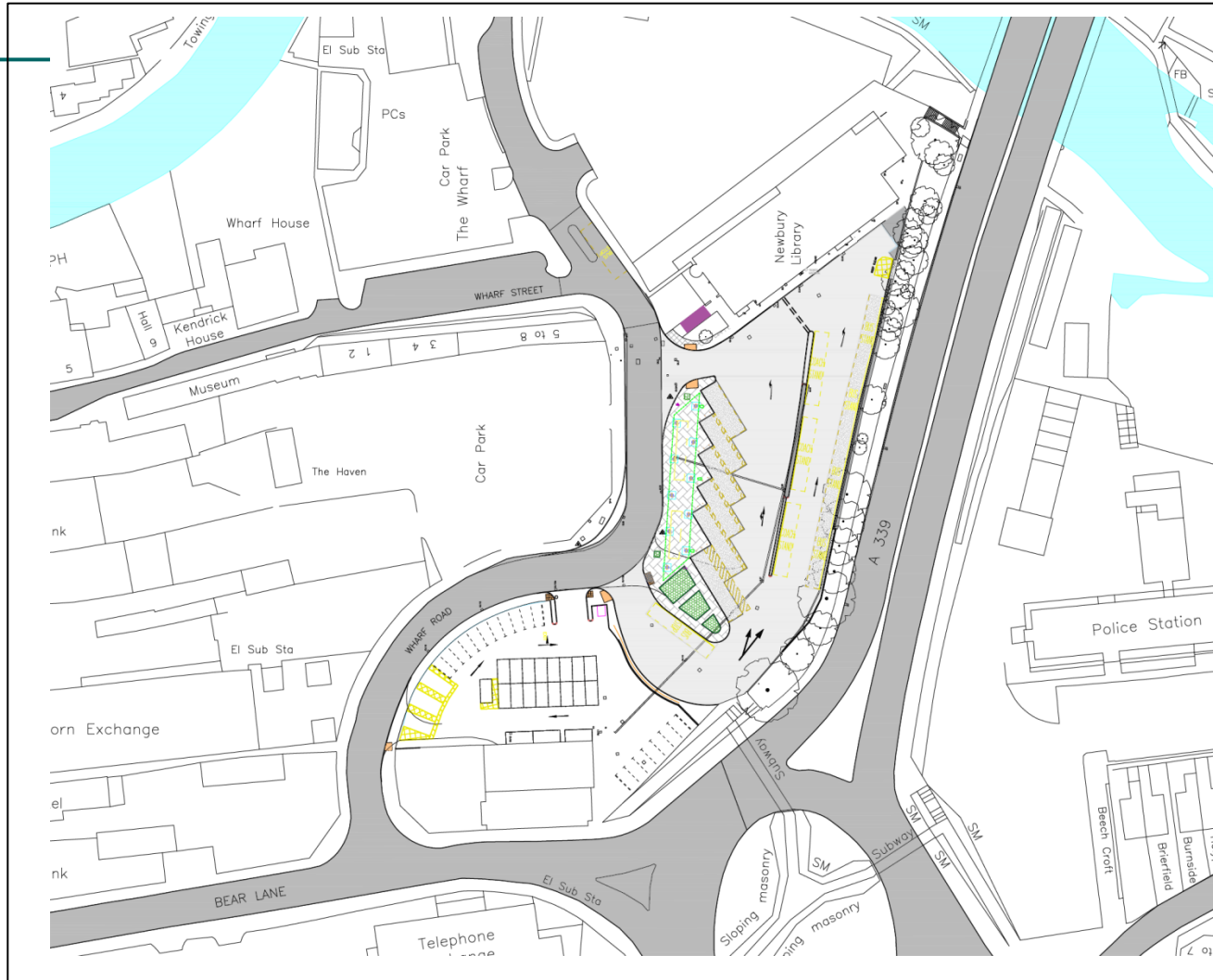



PROPOSED VIEW LOOKING NORTH ALONG WHARF ROAD



PROPOSED VIEW LOOKING SOUTH ALONG WHARF ROAD

**DESIGN STUDY 4 - SINGLE STRUCTURE COVERING INDIVIDUAL ENCLOSURES**

**PROPOSED VIEWS**



# Existing view from south



# Proposed view from south



DESIGN STUDY 4 - SINGLE STRUCTURE COVERING INDIVIDUAL ENCLOSURES

PHOTO INSERTION A WITHOUT TREES - VIEW NORTH



# Existing view from north

---



# Proposed view from north



DESIGN STUDY 4 - SINGLE STRUCTURE COVERING INDIVIDUAL ENCLOSURES

PHOTO INSERTION B WITHOUT TREES - VIEW SOUTH

Sutton Griffin  
ARCHITECTS  
Part of the **Carter Jonas** network



# Car Club

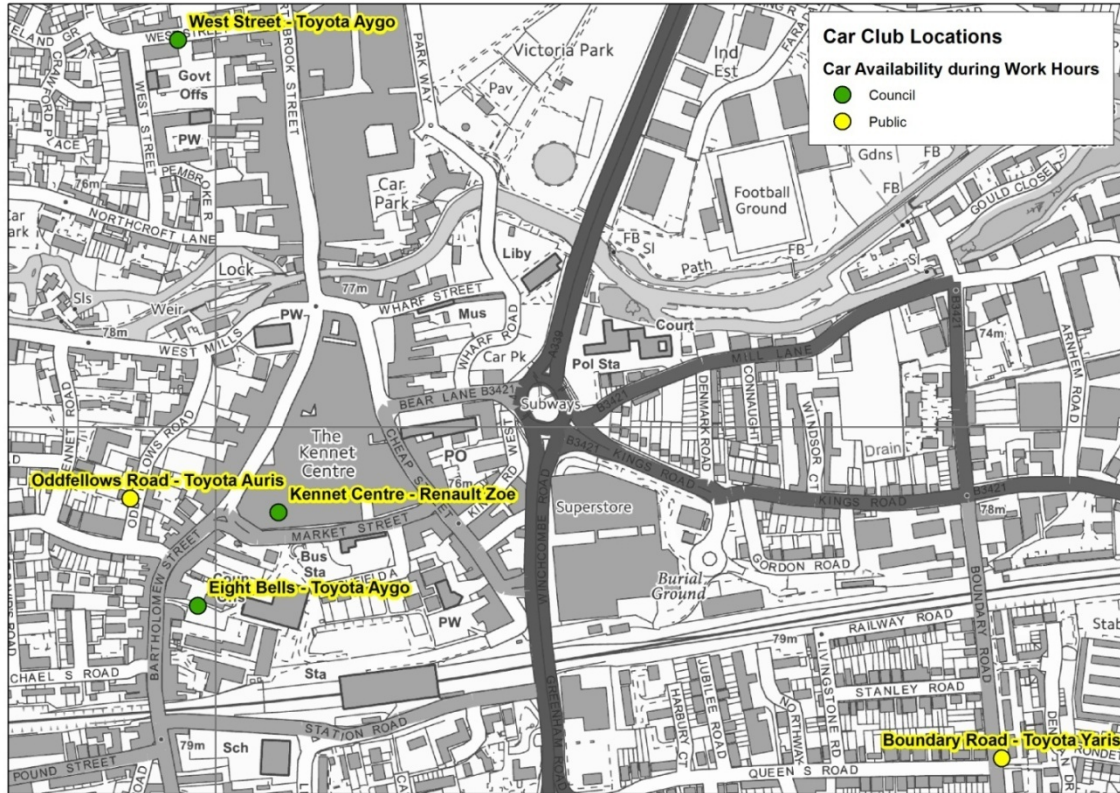

5 cars in Newbury's Car Club (one electric car)

Operated by Co-Wheels

Pay as you go car hire

Easy bookings and smart card technology to access vehicles



# Vehicles



Car in Eight Bells Car Park –  
Toyota Aygo



Toyota Auris in Oddfellows Road



Toyota Aygo outside West Street House

# Town Centre Car Share Group

- ❑ Coming soon! - Working with Newbury BID
- ❑ Using FAXI platform
- ❑ Linking regular town centre trips

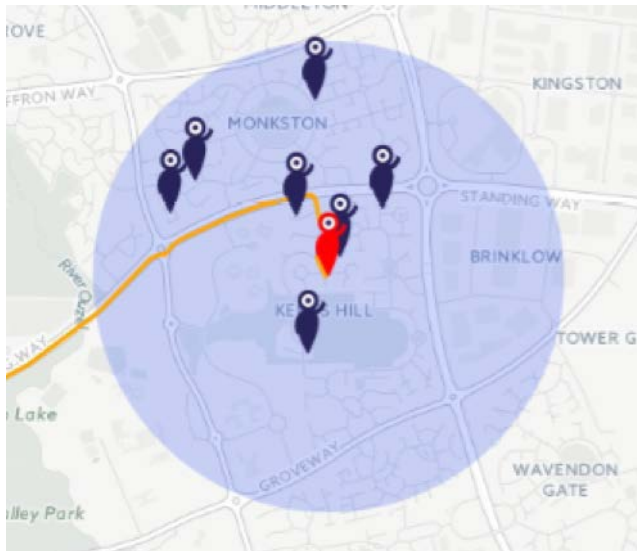

Find a  
car share  
partner  
with Faxi



# Highway Infrastructure Improvements

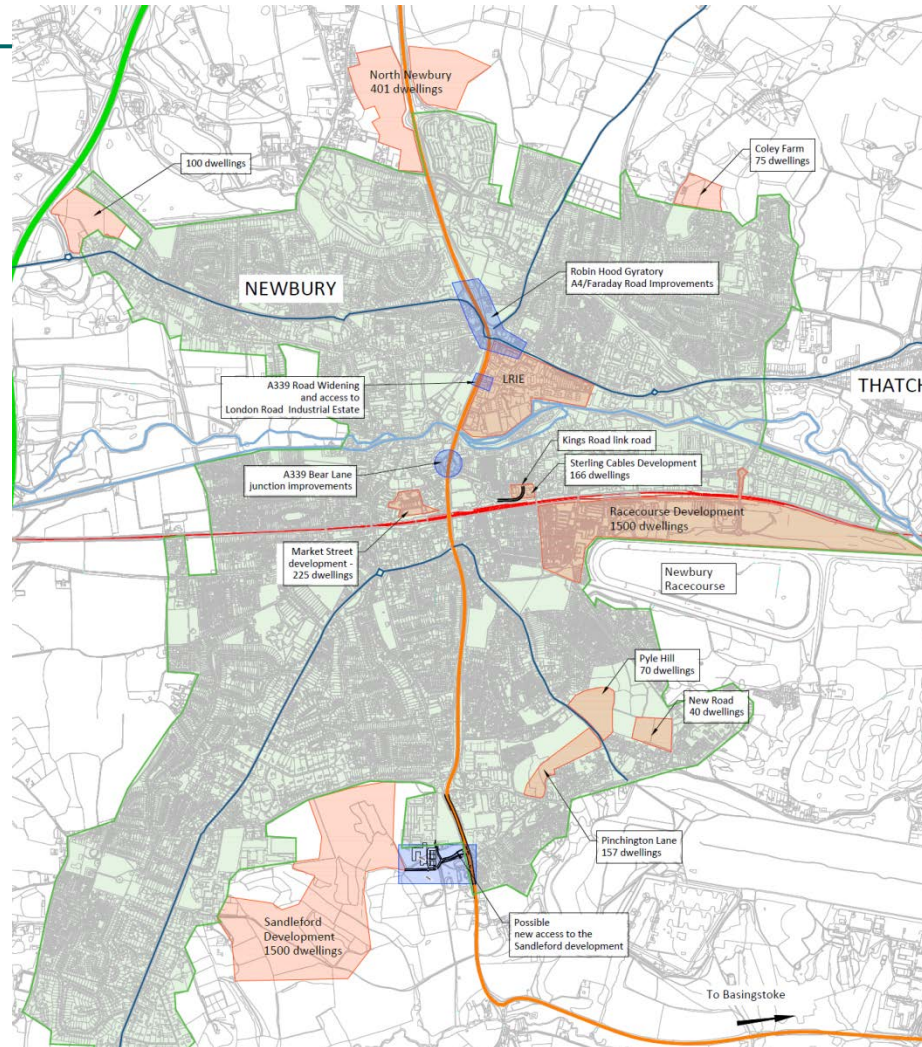



# Traffic Modelling

---

- ❑ Visual Simulation modelling (VISSIM for short);
- ❑ Existing scenario with traffic growthed to 2021;
- ❑ Committed developments included;
- ❑ Proposed improvements included;
- ❑ Comparison made between the 'with' and 'without' scheme scenario.

# Overview of VISSIM Model



# Robinhood Preferred Scheme

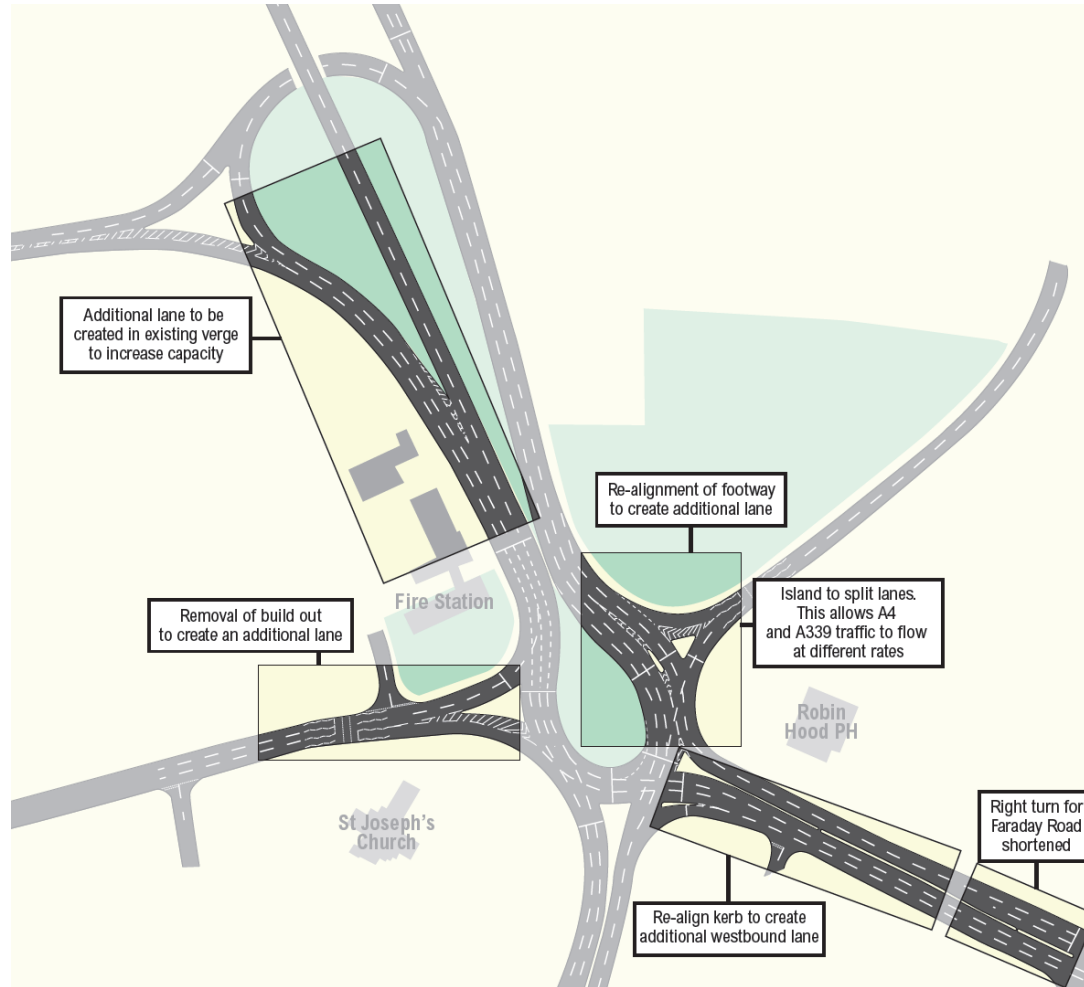



# Bear Lane Improvements

---

What problem are we trying to solve

- ❑ Inadequate queue space for right turn vehicles;
- ❑ Queuing through adjacent junctions on the A339;
- ❑ Exit blocking of Kings Road and Bear Lane;
- ❑ Accommodate additional development traffic;
- ❑ Design something that is buildable;

Numerous Options have been considered.

# Options – Hamburger Roundabout

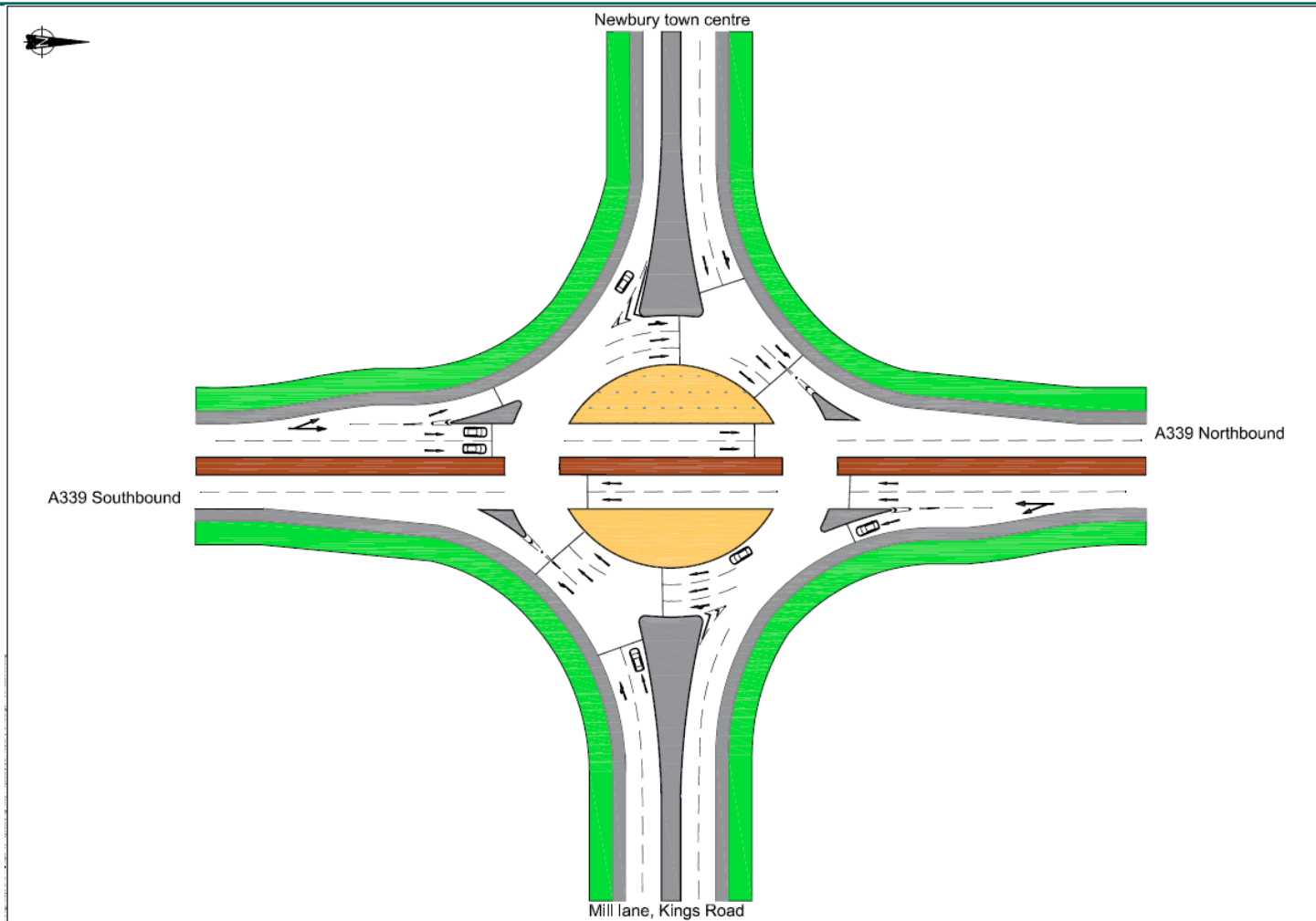

# Options – Double Roundabout

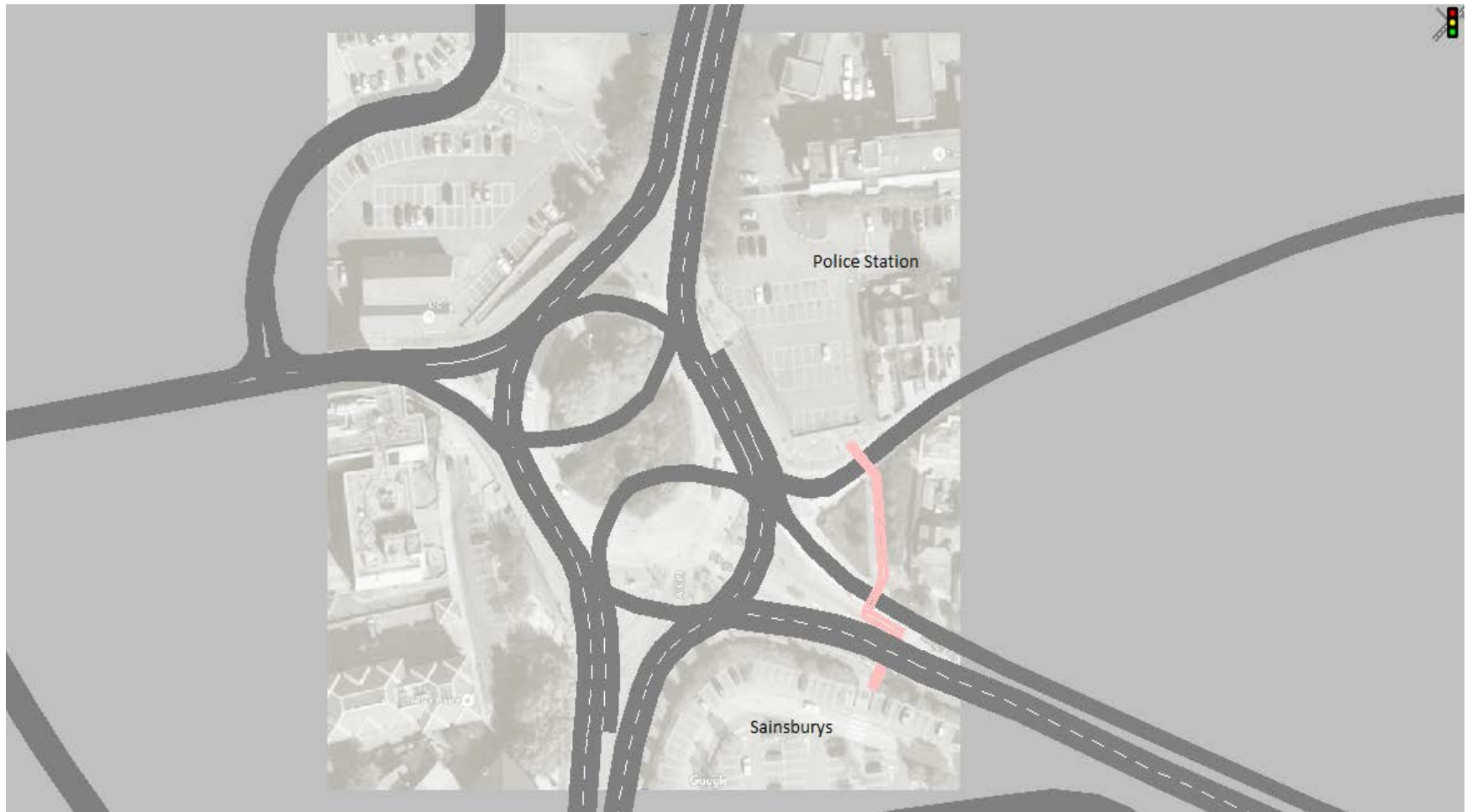



# Options - Flyover

---



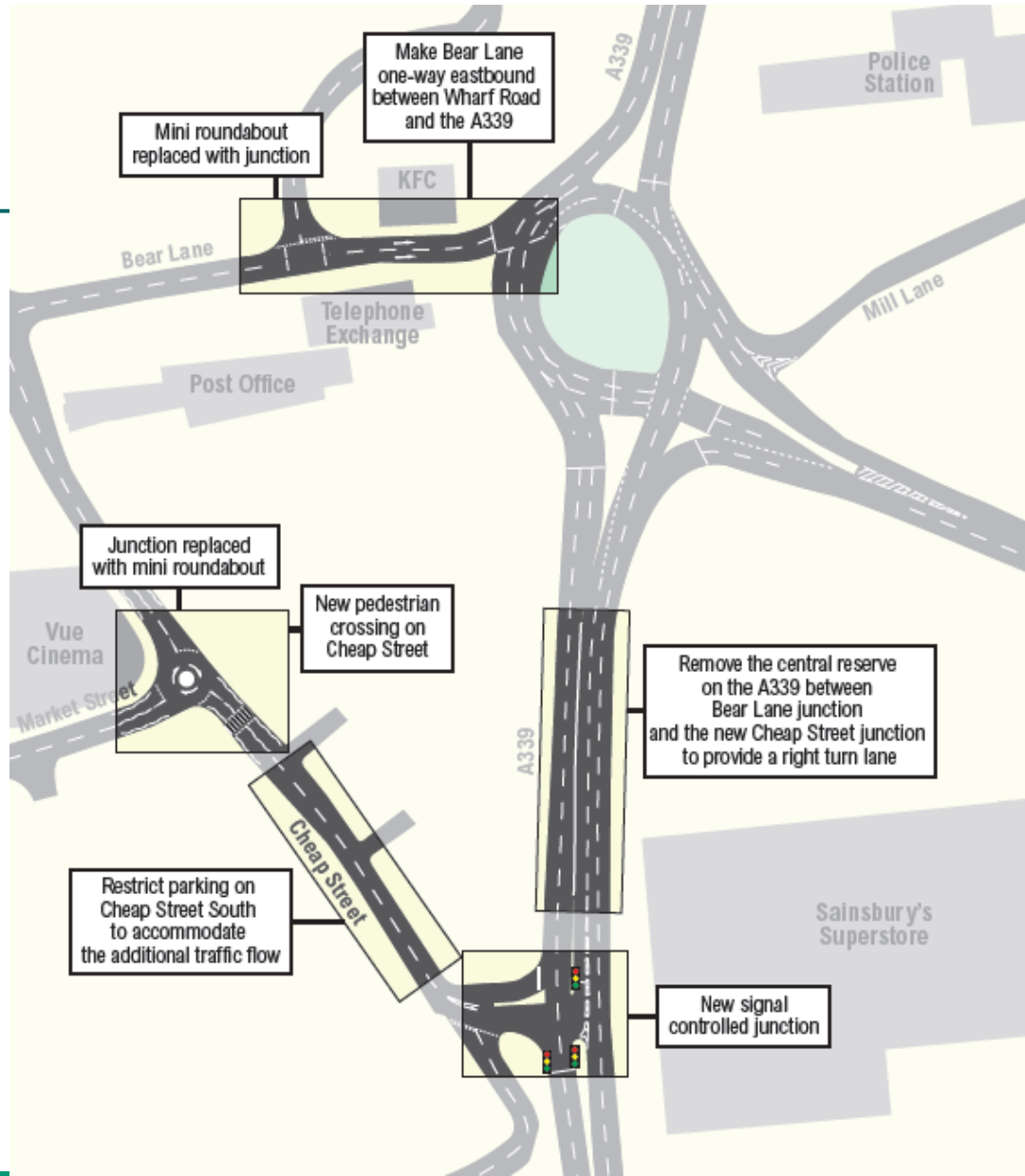

# The Way Forward

---

## **Bear Lane Improvements:**

- ❑ Consult May/June 2017 [www.westberks.gov.uk/A339](http://www.westberks.gov.uk/A339)
- ❑ Possible construction Feb 2018 for 9 months.

## **Kings Road Link Road:**

- ❑ Currently programmed to complete March 2019 (Part funded by Local Enterprise Partnership).

## **Robinhood Improvements:**

- ❑ Dependent on funding from North Newbury development.



# How you can get involved

---

- ❑ Engage in the current consultation 2017  
[www.westberks.gov.uk/A339](http://www.westberks.gov.uk/A339)
  
- ❑ Get in touch with any further questions or comments about delivering transport to support the Vision for Newbury:
  - Jon.Winstanley@westberks.gov.uk
  - Jenny.Graham@westberks.gov.uk